

INSTALLATION INSTRUCTIONS

GLOWRING PENDANT WITH C1NB HANGING SYSTEM

These instructions cover the GLOWRING luminaire with the following options:

SERIES	HANGING SYSTEM	SIZE	LIGHT SOURCE	CONTROL	WIRE DIAGRAM
1. GL1(GLOWRING)	C1NB: RECESSED CEILING MOUNT	24"	STATIC WHITE	DM1: 0-10V DIM 1%	WIRE DIAGRAM ON PAGE 6
		36"		DM3: LUTRON HILUME ECOSYSTEM 1% (LDE1)	
		48"			

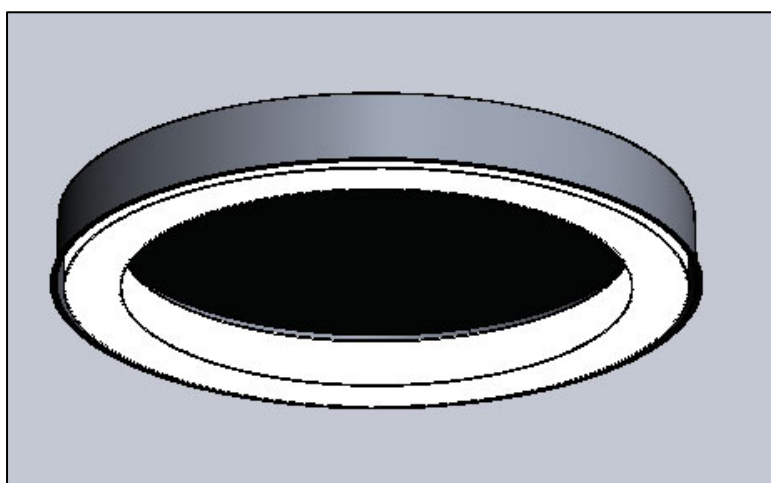

FIG. 1 - GL1-C1NB-XX-MW-XXX-LEDX_XXK-UNV-DM~

GENERAL NOTES:

- PLEASE COMPLETELY READ THE INSTALL INSTRUCTIONS BEFORE STARTING INSTALLATION.
- INSTALL IN ACCORDANCE WITH ALL LOCAL, STATE AND NATIONAL CODES CONSULT WITH A QUALIFIED ELECTRICIAN FOR PROPER INSTALLATION.
-CE PRODUIT DOIT ÊTRE INSTALLÉ SELON LE CODE D'INSTALLATION PERTINENT, PAR UNE PERSONNE QUI CONNAÎT. CONSULTER UNE ÉLECTRICIEN QUALIFIÉ POUR VOUS ASSURER QUE LES CONDUCTEURS DE LA DÉRIVATION SONT ADÉQUATS.
- CAREFULLY UNPACK ALL CONTENTS; SOME COMPONENTS MAY HAVE BEEN SHIPPED IN SEPARATE BOXES. MOST FIXTURES ARE SHIPPED PARTIALLY ASSEMBLED. SOME UNASSEMBLY MAY BE REQUIRED FOR INSTALLATION.
- FIXTURE POWER CORD WIRES ARE LOW- VOLTAGE. DO NOT CONNECT TO LINE VOLTAGE OR DAMAGE TO THE FIXTURE WILL OCCUR AND WARRANTY WILL BE VOIDED.
- DO NOT LET THE GLOWRING LUMINAIRE HANG FREE UNTIL ALL THE CABLES ARE SECURED AND EVENLY TENSIONED.
- KEEP HANDS AWAY FROM THE SILICONE DIFFUSER. DO NOT TOUCH IT AT ALL TIMES.
- DUE TO A CHANGE IN NEC SECTION 410.69 EFFECTIVE IN 2022, THE COLOR PINK WILL BE USED IN PLACE OF GRAY FOR 0-10V CONTROL. NOTE THAT EXISTING SYSTEMS AND FIXTURES MANUFACTURED PRIOR TO 2022 MAY STILL USE GRAY WIRE AS AN UNGROUNDED CONDUCTOR FOR 0-10V CONTROL. CARE SHOULD BE TAKEN WHEN WORKING ON EXISTING SYSTEMS.

OCL Architectural Lighting

Phone: 314.863.1895
Fax: 314.863.3278
www.ocl.com

Table of Contents

GENERAL INFORMATION:	3
INSTALLATION PREPARATION:	4
FIXTURE PREPARATION:	5
FIXTURE MOUNTING:	7

GLX-C1NB-ALLSIZES_INSTALLATION INSTRUCTIONS

GENERAL INFORMATION:

You will receive the following with each GLOWRING series Ceiling fixture:

1. GLOWRING LUMINAIRE. (Pre-assembled as shown in FIG. 2)
2. INSTALLATION INSTRUCTIONS (shown in FIG. 3) - Please completely read the install instructions before starting installation.

WARNING: Examine all components for any damage before beginning installation.

WARNING: This fixture should be installed by a licensed electrician only.

WARNING: Be careful not to scratch or damage any finished parts.

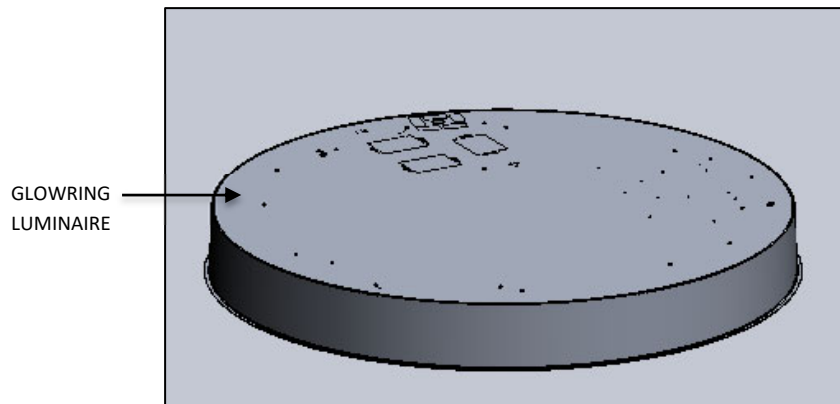

FIG.2 GLOWRING LUMINAIRE (PRE-ASSEMBLED)

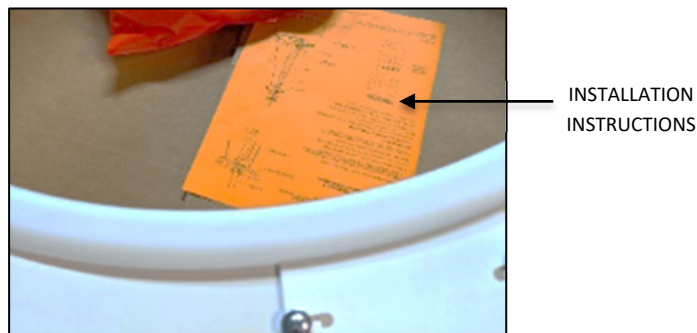

FIG.3 INSTALLATION INSTRUCTION

OCL Architectural Lighting

Phone: 314.863.1895

Fax: 314.863.3278

www.ocl.com

INSTALLATION PREPARATION:

1. If applicable, cut a hole in Ceiling surface to make room for GLOWRING RECESSED HOUSING. See MOUNTING INFORMATION TABLE below for Ceiling Cutout Dimension.

MOUNTING INFORMATION TABLE												
SERIES	LUMINAIRE DIAMETER	LUMINAIRE WEIGHT	DIM A	RADIUS B	SUPPORT POSITION		MOUNTING HOLE POSITION					CEILING CUT OUT DIA. (+/- 0.125)
					DIM C	DIM D	DIM E	DIM F	DIM G	DIM H	MOUNTING POINTS	
 GL1 (GLOWRING)	24"	16LBS	16"	10"	5.66"	11.31"	5.66"	11.31"	-	-	4	25.125"
	36"	28LBS	28"	16"	9.9"	19.8"	9.9"	19.8"	-	-	4	37.125"
	48"	60LBS	40"	22"	17.32"	34.64"	10"	20"	20"	40"	6	49.125"

2. Install UNISTRUT per dimensions shown in FIG.5 [prior to closing ceiling].
3. Install 1/4-20 ROD (by others) at Mounting location as per the Mounting information Table. 1/4-20 ROD should protrude past the bottom of the ceiling surface 0.375" as shown in FIG.4.
4. Install UNISTRUT into 1/4-20 THREADED RODS in locations shown in fig. 5. [24" and 36" sizes will have four rods and the 48" size will have six]. 1/4-20 THREADED RODS should protrude through the RECESSED HOUSING by a minimum of 0.375" and a maximum of 0.5", as shown on FIG.6.

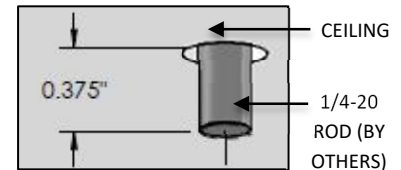

FIG. 4 – GRID CEILING INSTALLATION

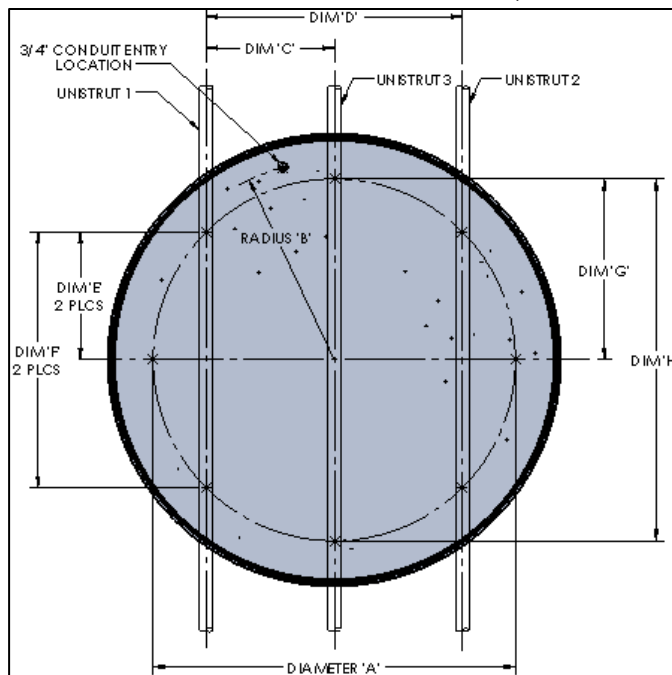

FIG. 5 – MOUNTING INFORMATION

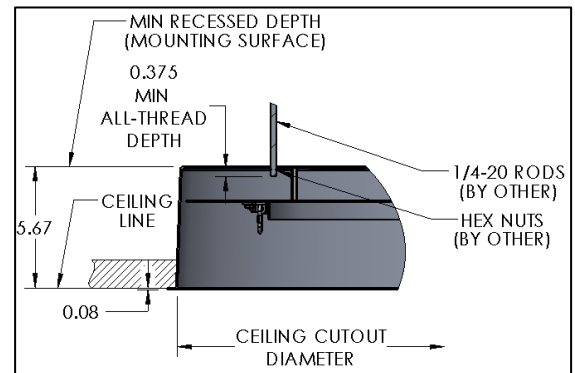

FIG. 6 – THREADED ROD INSTALLATION

NOTE:

For 24" and 36" fixtures:

- Use 4x $\varnothing 0.281$ mounting locations, spaced at 90°
- Use UNISTRUTS 1 & 2 only

For 48" fixtures:

- Use 8x $\varnothing 0.281$ mounting locations spaced at 45°
- Use all 3 UNISTRUTS

5. Route conduit (by other) to conduit entry location as shown in FIG.5.

OCL Architectural Lighting

Phone: 314.863.1895

Fax: 314.863.3278

www.oclighting.com

GLX-C1NB-ALLSIZES_INSTALLATION INSTRUCTIONS

FIXTURE PREPARATION:

1. Unpackage fixture and separate GLOWRING ASSEMBLY from RECESSED HOUSING by rotating GLOWRING ASSEMBLY counterclockwise as shown in FIG.7.

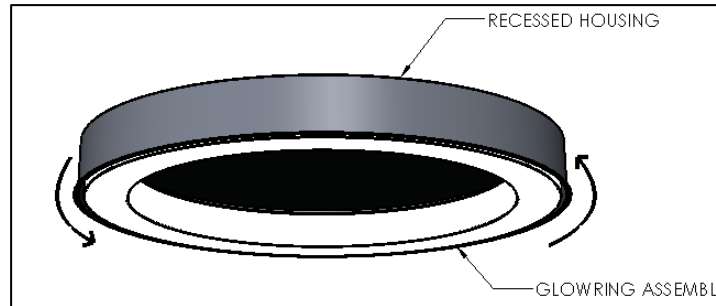

FIG. 7 – DISASSEMBLY OF GLOWRING ASSEMBLY FROM HOUSING

2. Unscrew KNURL NUTS securing MOUNTING TRAY to RECESSED HOUSING. Carefully remove MOUNTING TRAY from RECESSED HOUSING shown in FIG.8 and set aside. Be careful not to damage finish.

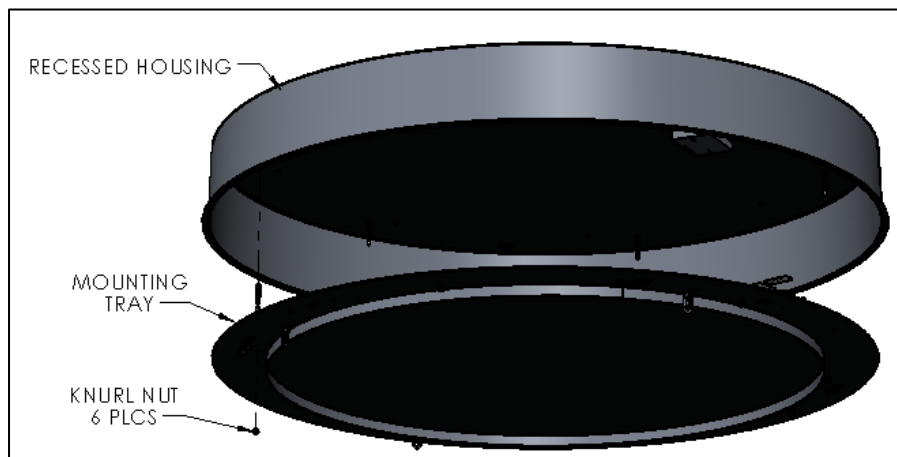

FIG. 8 – DISASSEMBLY OF MOUNTING TRAY FROM HOUSING

3. With multiple people, raise RECESSED HOUSING to ceiling and connect conduit to recessed shown in FIG.9, Mount RECESSED HOUSING by fastening to 1/4-20 threaded rods (installed in step 3 of INSTALLATION PREPARATION procedure) with hex nut [by other], ensuring that the flange on recessed housing coincides with the designated height of the grid ceiling.

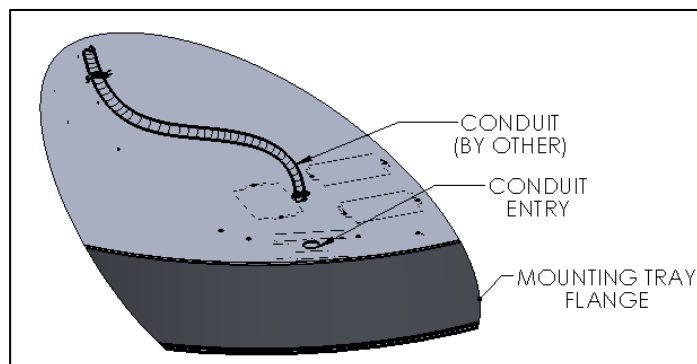

FIG. 9 – CONNECTING CONDUIT TO RECESSED HOUSING

OCL Architectural Lighting

Phone: 314.863.1895

Fax: 314.863.3278

www.ocl.com

GLX-C1NB-ALLSIZES_INSTALLATION INSTRUCTIONS

4. Feed building supply wires into the RECESSED HOUSING and make all wire connections in accordance with the NATIONAL ELECTRIC CODE and applicable LOCAL AND STATE CODES. See WIRE CONNECTION INFORMATION and WIRE DIAGRAM below for wire connections as shown in FIG.10 & 11.

WIRE DIAGRAM TABLE						
SERIES	HANGING SYSTEM	SIZE	LIGHT SOURCE	CONTROL	LED OUTPUT	WIRE DIAGRAM
GL1(GLOWRING)	C1NB: RECESSED CEILING MOUNT	24"	STATIC WHITE	DM1: 0-10V DIM 1%	LED1 LED2	WIRE DIAGRAM ON PAGE 6
		36"		DM3: LUTRON HILUME ECOSYSTEM 1% (LDE1)		
		48"				

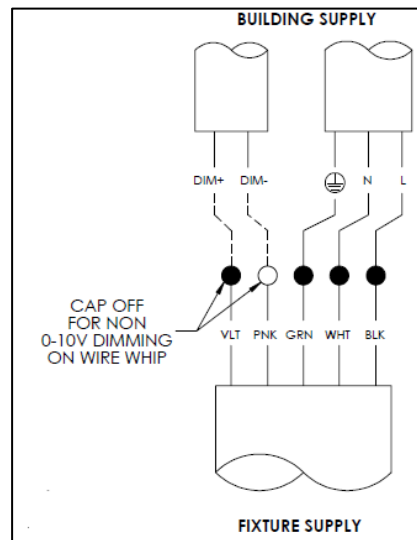

FIG. 10 – WIRE CONNECTION INFORMATION BETWEEN BUILDING SUPPLY AND FIXTURE

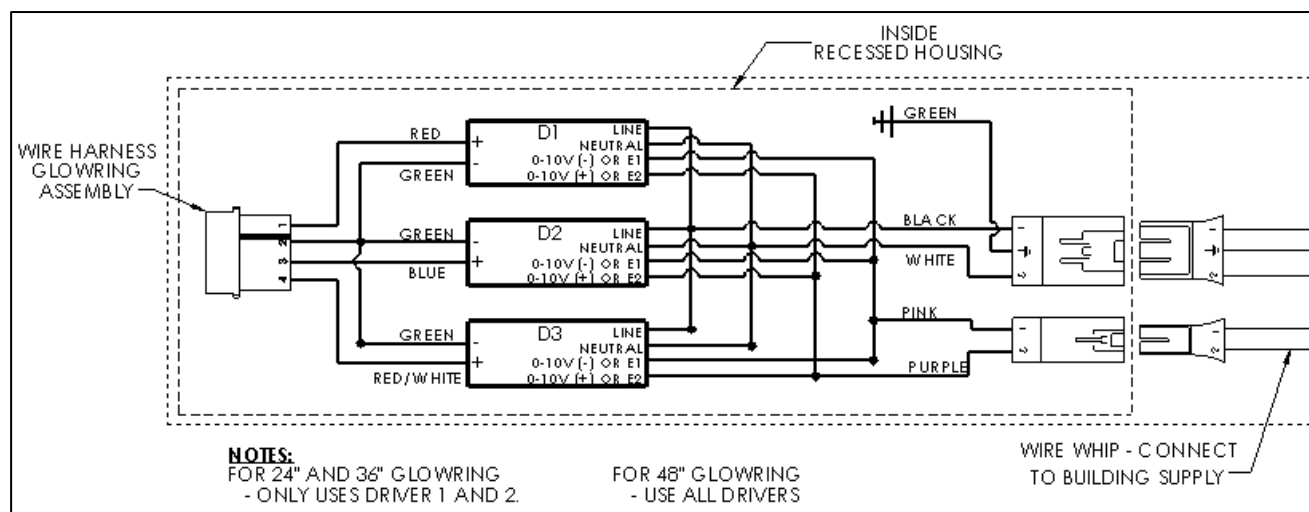

FIG. 11 – WIRE DIAGRAM

OCL Architectural Lighting

Phone: 314.863.1895

Fax: 314.863.3278

www.oclighting.com

FIXTURE MOUNTING:

1. Raise MOUNTING TRAY and route WIRE HARNESS through slotted WIRE WAY HOLE on MOUNTING TRAY as shown in FIG.12 Install MOUNTING TRAY re-using hardware as shown in FIG.13 (removed from step 2 of FIXTURE PREPARATION). Make sure all KNURL NUTS are securely fastened.

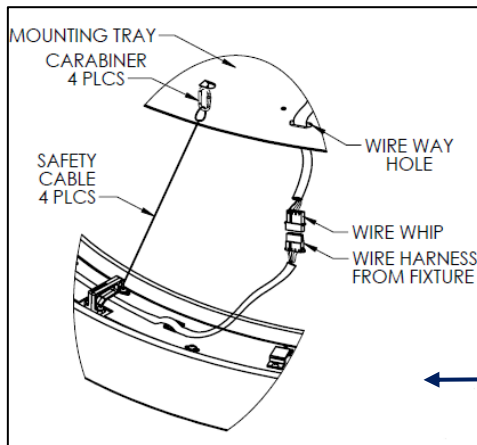

FIG. 12 – DETAIL SHOWING SAFETY CABLE
& WIRE CONNECTION INFORMATION

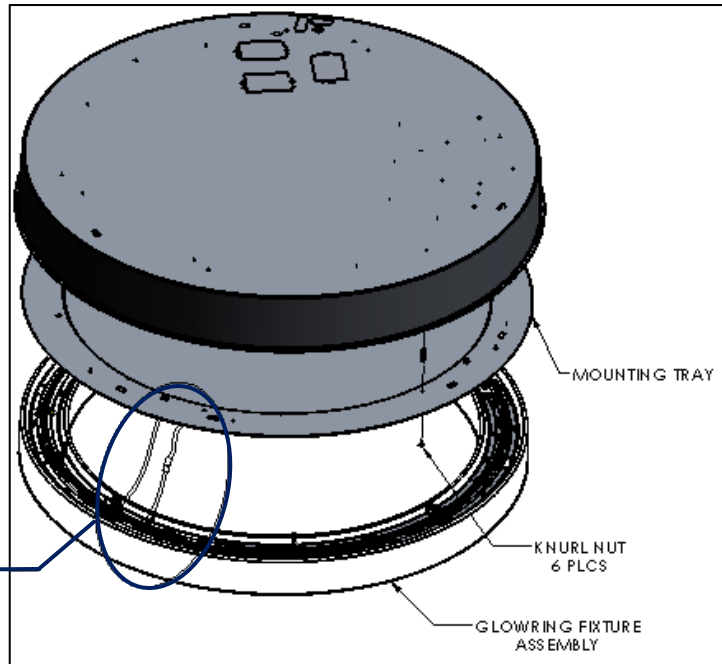

FIG. 13 – MOUNTING TRAY INSTALLATION

2. With multiple people, raise up GLOWRING FIXTURE ASSEMBLY and attach the provided SAFETY CABLES as shown in FIG.14 to the carabiners on MOUNTING TRAY. Be sure to orient GLOWRING ASSEMBLY so WIRE HARNESES align as shown in FIG.12.
3. Connect WIRE HARNESS on GLOWRING ASSEMBLY to WIRE WHIP previously feed through MOUNTING TRAY in step 1. Tuck excess HARNESS back into RECESSED HOUSING.

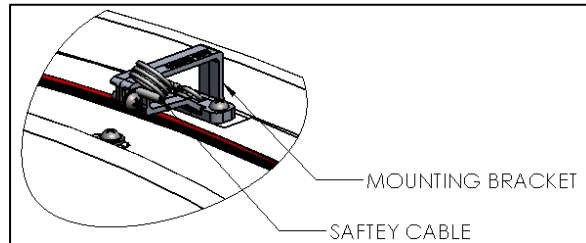

FIG. 14 – SAFETY CABLE INSTALLATION WITH BRACKET

4. Rotate GLOWRING ASSEMBLY counterclockwise to raise the fixture up to the MOUNTING TRAY as show in FIG 15.

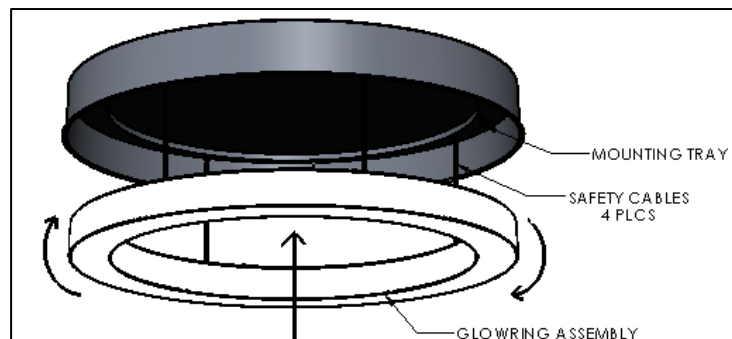

FIG. 15 – GLOWRING ASSEMBLY INSTALLATION

OCL Architectural Lighting

Phone: 314.863.1895

Fax: 314.863.3278

www.oclighting.com

GLX-C1NB-ALLSIZES_INSTALLATION INSTRUCTIONS

5. Once tight against MOUNTING TRAY, rotate GLOWRING ASSEMBLY clockwise (while applying upward force) until you hear/feel fixture engage MOUNTING CLIPS as shown in FIG.16. It may take force to overcome and engage mounting clips. Once engaged, remove upward pressure and softly rotate fixture counterclockwise to ensure fixture is fully seated in MOUNTING CLIPS.

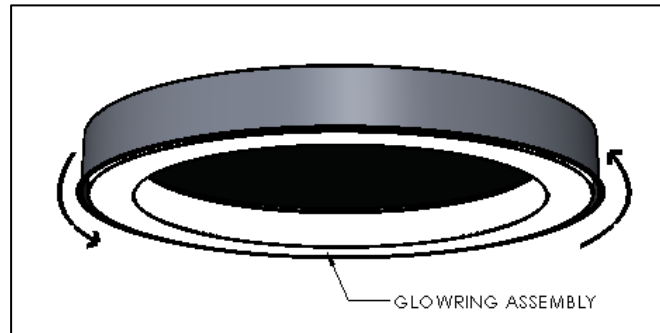

FIG. 16 – FINAL INSTALLATION

5. Restore power to circuit the GLOWRING series Ceiling is connected to.
 - a. Test to see that the luminaire turns on after power is restored.
 - b. Contact OCL for any luminaire troubleshooting if a problem occurs.



FIG. 17 - COMPLETED INSTALLATION
OF GLOWRING CEILING WITH C1NB
HANGING SYSTEM
GL1 (GLOWRING) (SHOWN)

OCL Architectural Lighting

Phone: 314.863.1895

Fax: 314.863.3278

www.ocl.com