

INSTALLATION INSTRUCTIONS ARO PENDANT WITH P1EU HANGING SYSTEM

These instructions cover the ARO LUMINAIRE with the following options:

SERIES	HANGING SYSTEM	SIZE	LIGHT SOURCE	CONTROL	WIRE DIAGRAM
1. AO2(ARO)	P1EU: PENDANT WITH 4 ANGLED AIRCRAFT CABLES AND POWER CORD TO CANOPY; MOUNTS TO 4X4 OCTAGON J-BOX (BY OTHERS) REMOTE DRIVER ENCLOSURE	24"	STATIC WHITE	0-10V DIM 1% (DM1)	WIRE DIAGRAM A ON SHEET 5
		36"	STATIC WHITE	0-10V DIM 1% (DM1)	WIRE DIAGRAM A ON SHEET 5
		48"	STATIC WHITE	0-10V DIM 1% (DM1)	WIRE DIAGRAM A ON SHEET 5
		60"	STATIC WHITE	0-10V DIM 1% (DM1)	WIRE DIAGRAM A ON SHEET 5
		72"	STATIC WHITE	0-10V DIM 1% (DM1)	WIRE DIAGRAM B ON SHEET 6

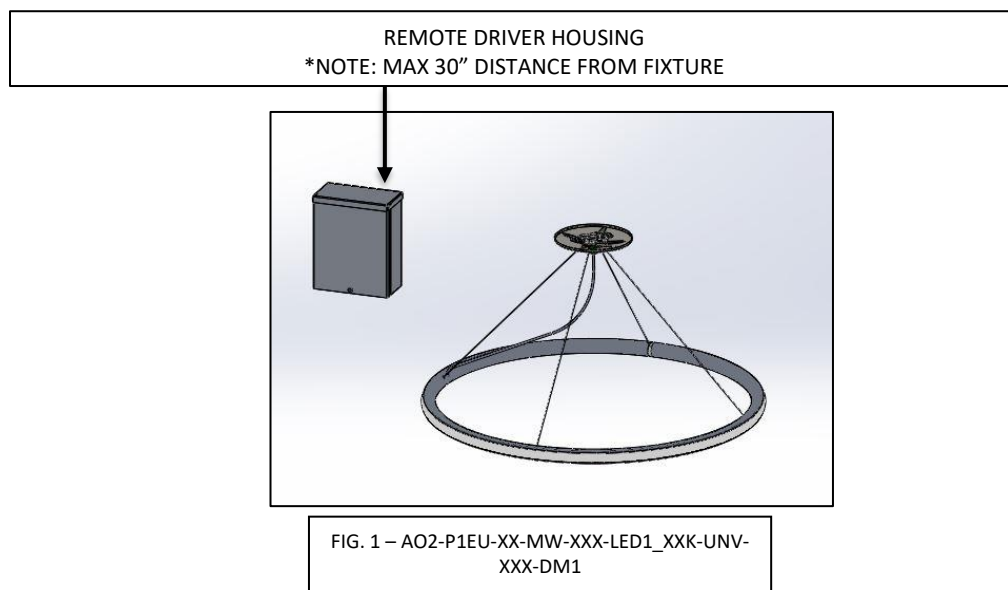

GENERAL NOTES:

- PLEASE COMPLETELY READ THE INSTALL INSTRUCTIONS BEFORE STARTING INSTALLATION.
- TURN OFF POWER TO CIRCUIT FIXTURE WHILE IT IS BEING INSTALLED.
- INSTALL IN ACCORDANCE WITH ALL LOCAL, STATE AND NATIONAL CODES CONSULT WITH A QUALIFIED ELECTRICIAN FOR PROPER INSTALLATION.
- CAREFULLY UNPACK ALL CONTENTS; SOME COMPONENTS MAY HAVE BEEN SHIPPED IN SEPARATE BOXES. MOST FIXTURES ARE SHIPPED PARTIALLY ASSEMBLED. SOME UNASSEMBLY MAY BE REQUIRED FOR INSTALLATION.
- REMOTE MOUNTING DRIVERS - OCL RECOMMENDS: MAX 30' DISTANCE FROM FIXTURE FOR NON-DIMMING, DMO DM1 AND MAX 10' REMOTE DISTANCE FOR LUTRON. ENCLOSURE SHOULD REMAIN ACCESSIBLE AFTER INSTALLATION.
- DO NOT LET THE ARO LUMINAIRE HANG FREE UNTIL ALL THE AIRCRAFT CABLES ARE SECURED AND EVENLY TENSIONED.

OCL Architectural Lighting

Phone: 314.863.1895
Fax: 314.863.3278
www.ocl.com

Table of Contents

GENERAL INFORMATION:	3
REMOTE DRIVER MOUNTING:.....	4
WIRE DIAGRAM A (FOR 24", 36", 48" AND 60"):	5
WIRE DIAGRAM B (FOR 72"):	6
MOUNTING:.....	7
ARO MOUNTING [CANOPY]:	7
CORD INSTALLATION INSTRUCTIONS	9

AO2-P1EU-INSTALLATION INSTRUCTIONS

GENERAL INFORMATION:

You will receive the following with each ARO P1EU series pendant fixture:

1. ARO LUMINAIRE with CORD and AIRCRAFT CABLE attached. (Pre-assembled as shown in FIG. 2)
2. INSTALLATION INSTRUCTIONS (shown in FIG. 3) - Please completely read the install instructions before starting installation.
3. RED BAG (shown in FIG. 3) contains below following items.
 - a. CANOPY (Grounding wires Pre-assembled as shown in FIG. 4)
 - b. MOUNTING KIT (as shown in FIG. 5)
 - i. FINIAL
 - ii. MOUNTING BRACKET ASSEMBLY
4. REMOTE DRIVER BOX WITH DRIVER INSTALLED (as shown in FIG. 6)

WARNING: Examine all components for any damage before beginning installation.

WARNING: This fixture should be installed by a licensed electrician only.

WARNING: Be careful not to scratch or damage any finished parts.

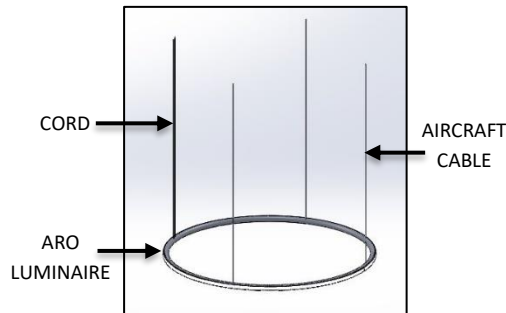

FIG. 2 - ARO LUMINAIRE
(PRE-ASSEMBLED)

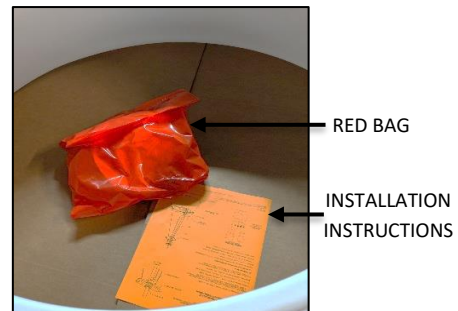

FIG.3 RED BAG AND
INSTALLATION INSTRUCTIONS

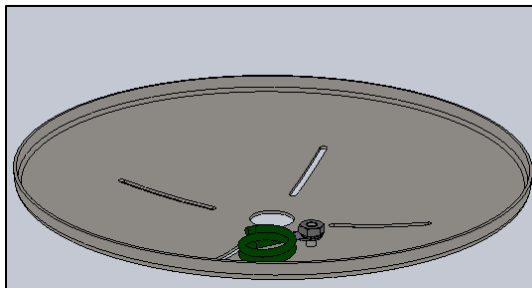

FIG. 4 - CANOPY

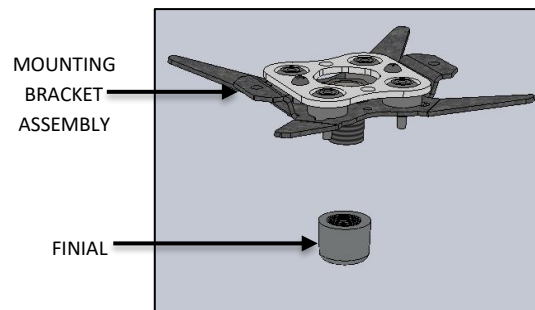

FIG. 5 - MOUNTING KIT CONTENTS

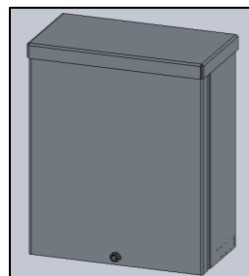

FIG. 6 - REMOTE DRIVER BOX
WITH DRIVER INSTALLED

OCL Architectural Lighting

Phone: 314.863.1895

Fax: 314.863.3278

www.ocl.com

REMOTE DRIVER MOUNTING:

1. Shut off power.
2. Remove the lid of the REMOTE DRIVER HOUSING as shown in FIG. 7 and FIG. 8 below.

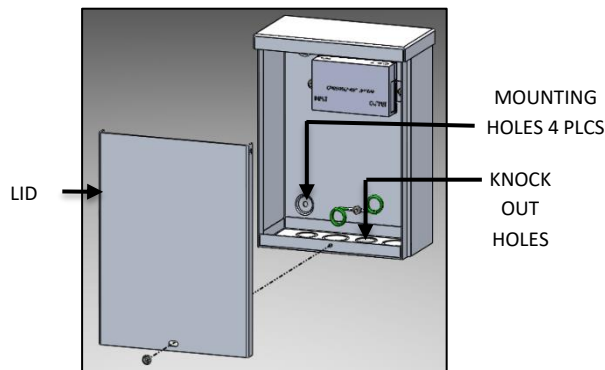

FIG. 7 – REMOTE DRIVER BOX ASSEMBLY FOR 24, 36, 48 AND 60 MODELS

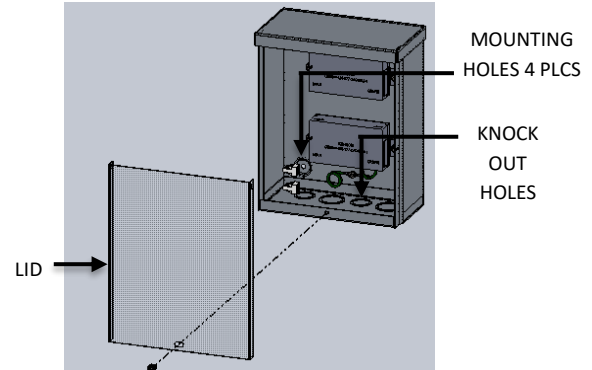

FIG. 8 – REMOTE DRIVER BOX ASSEMBLY FOR 72 MODEL

3. Mount the REMOTE DRIVER HOUSING to code in a location that is 30 feet or less from the FIXTURE BODY and is accessible after installing. Max wire length is 30ft measured from the FIXTURE BODY to the DRIVER.
4. Using the knockout holes at the bottom of the remote box, run conduit into the remote box for the building supply wires (line voltage) and conduit out of the remote box for the fixture wire (low voltage). Conduit, adapters and wires are supplied by other.

NOTE: Do not run Line Voltage and Low Voltage wires in the same conduit.

5. Run a positive and negative 16 or larger gauge wire (by others) from the REMOTE DRIVER HOUSING to the junction box the fixture will mount to (by others). Inside the REMOTE DRIVER HOUSING, connect:
 - Driver LED output (+) and positive 16 or larger gauge wire.
 - Driver LED output (-) and negative 16 or larger gauge wire.
 - Dimming wires as shown on the driver in FIG. 9 and FIG. 10 below.

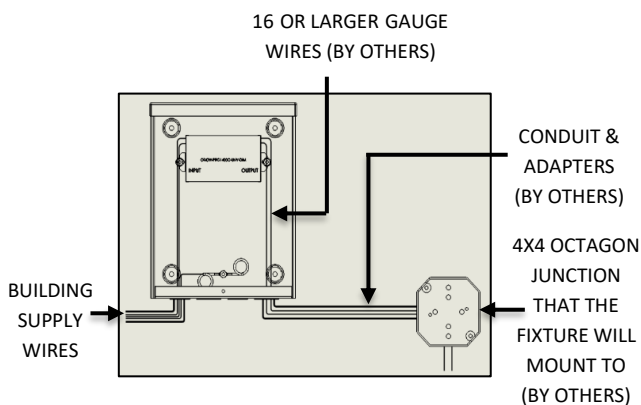

FIG. 9 – WIRE CONNECTION FROM BUILDING SUPPLY TO J-BOX FOR 24, 36, 48 AND 60 MODELS

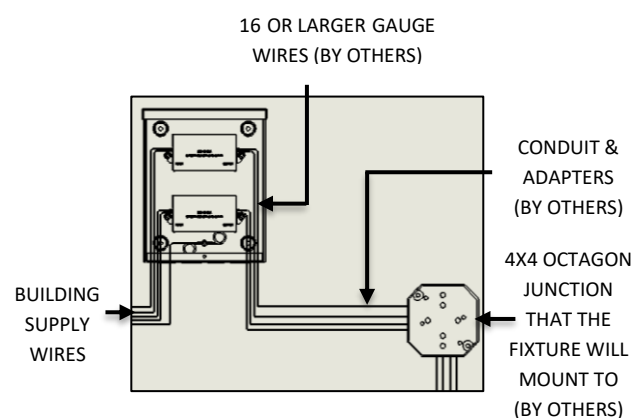

FIG. 10 – WIRE CONNECTION FROM BUILDING SUPPLY TO J-BOX FOR 72 MODEL

AO2-P1EU-INSTALLATION INSTRUCTIONS

- Connect building supply wires to the driver. Make all wire connections in accordance with the national electrical code and all applicable local and state codes. Refer WIRE DIAGRAM TABLE for corresponding WIRE DIAGRAM connections. Install the lid on the remote driver housing once connections are done.

WIRE DIAGRAM TABLE						
SERIES	HANGING SYSTEM	BODY SIZE	LIGHT SOURCE	LED OUTPUT	CONTROL	WIRE DIAGRAM
1.AO2(ARO)	P1EU	24"	STATIC WHITE	LED1	0-10V DIM 1% (DM1)	WIRE DIAGRAM A ON SHEET 5
	P1EU	36"	STATIC WHITE	LED1	0-10V DIM 1% (DM1)	WIRE DIAGRAM A ON SHEET 5
	P1EU	48"	STATIC WHITE	LED1	0-10V DIM 1% (DM1)	WIRE DIAGRAM A ON SHEET 5
	P1EU	60"	STATIC WHITE	LED1	0-10V DIM 1% (DM1)	WIRE DIAGRAM A ON SHEET 5
	P1EU	72"	STATIC WHITE	LED1	0-10V DIM 1% (DM1)	WIRE DIAGRAM B ON SHEET 6

WIRE DIAGRAM A (FOR 24", 36", 48" AND 60"):

- Connect building supply wires to the driver as per connections shown in FIG. 11.
- Connect the Fixture Cord wires as per WIRE LABEL TABLE and refer WIRE DIAGRAM as shown in FIG.12. below for exact wire connections.

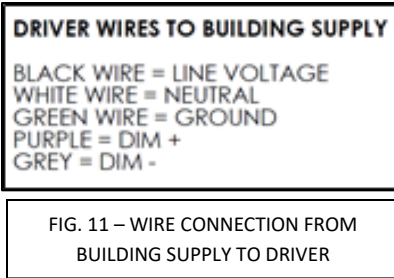

WIRE LABEL TABLE		
CONTROL	WIRE	LABEL
ALL	INSULATED WIRE	LED+
ALL	BRAIDED WIRE	LED-

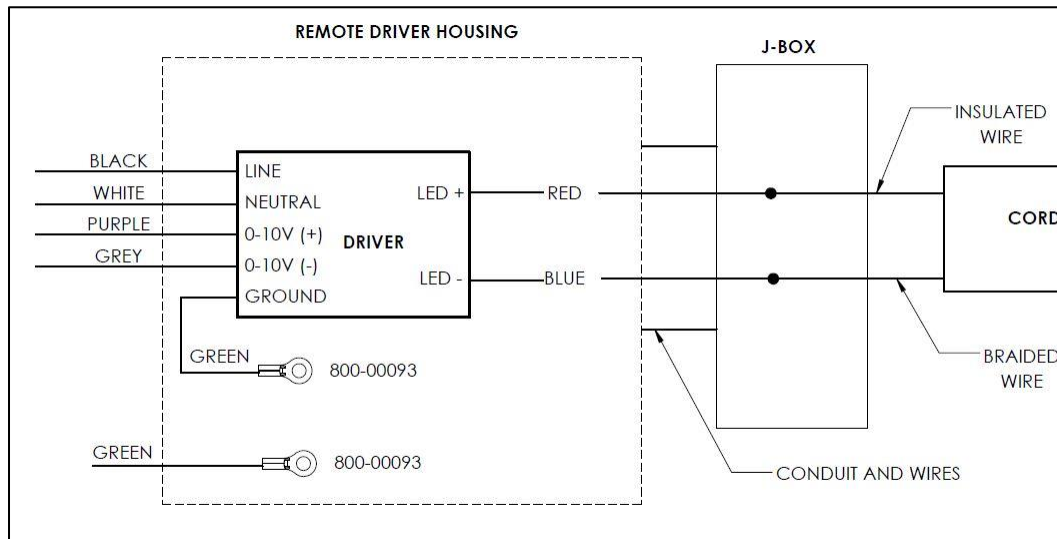

FIG. 12 – WIRE DIAGRAM FOR 24", 36", 48" AND 60" MODELS

OCL Architectural Lighting

Phone: 314.863.1895

Fax: 314.863.3278

www.ocl.com

WIRE DIAGRAM B (FOR 72"):

9. Connect building supply wires to the driver as per connections shown in FIG. 13.
10. Connect the Fixture Cord wires as per WIRE LABEL TABLE and refer WIRE DIAGRAM as shown in FIG. 14 below for exact wire connections.

WIRE LABEL TABLE		
CONTROL	WIRE COLOR	LABEL
ALL	INSULATED WIRE	DRIVER 1 LED+
ALL	BRAIDED WIRE	DRIVER 1 LED-
ALL	INSULATED WIRE	DRIVER 2 LED+
ALL	BRAIDED WIRE	DRIVER 2 LED-

DRIVER WIRES TO BUILDING SUPPLY

BLACK WIRE = LINE VOLTAGE
 WHITE WIRE = NEUTRAL
 GREEN WIRE = GROUND
 PURPLE = DIM +
 GREY = DIM -

FIG. 13 – WIRE CONNECTION FROM
BUILDING SUPPLY TO DRIVER

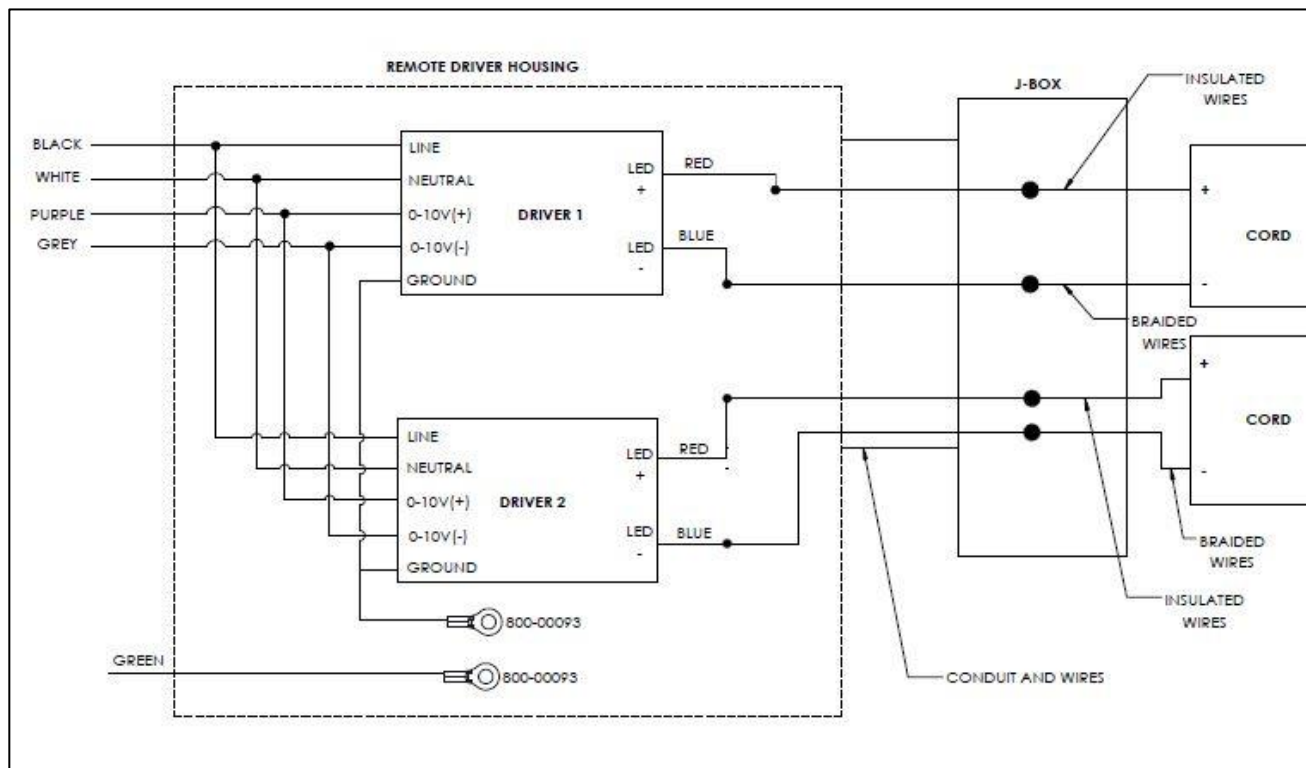

FIG. 14 – WIRE DIAGRAM FOR 72" MODEL

OCL Architectural Lighting

Phone: 314.863.1895

Fax: 314.863.3278

www.ocl.com

MOUNTING:

ARO MOUNTING [CANOPY]:

1. Loosen the CANOPY FINIAL and remove CANOPY as shown in FIG. 15. Assemble the MOUNTING BRACKET ASSEMBLY to the JUNCTION BOX the fixture will mount to (by others) with screws (by others) as shown in FIG. 16 below.

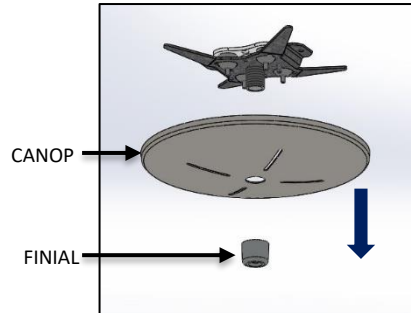

FIG. 15 – CANOPY DIS-ASSEMBLY

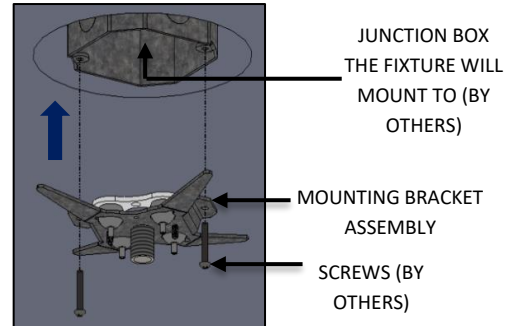

FIG. 16 – MOUNTING BRACKET ASSEMBLY INSTALLATION

2. Pass the CANOPY through the AIRCRAFT CABLE and CORD in such a way that the AIRCRAFT CABLE goes through the oblong slot holes and CORD passes through the center hole on the CANOPY as shown in FIG. 17 below.

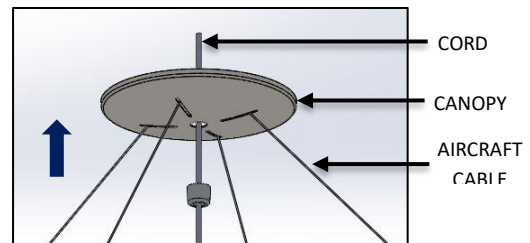

FIG. 17 – CANOPY PLATE INSTALLATION

3. Raise the ARO LUMINAIRE up, with multiple people, to the ceiling and feed the AIRCRAFT CABLE through the GRIPLOCK and CORD through NIPPLE which is available in MOUNTING BRACKET ASSEMBLY. Adjust the AIRCRAFT CABLE to the desired length as shown in FIG. 18 & 19 below.

NOTE: Make sure to trim the excess of AIRCRAFT CABLE, leaving at least 1.75" past the GRIPLOCK for the GRIPLOCK to function properly. Make sure that the aircraft cable is taped up above the GRIPLOCK, so there is no chance of anything shorts.

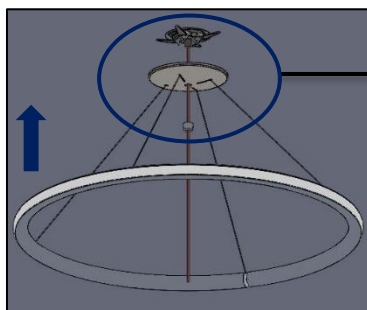

FIG. 18 - INSTALLATION VIEW

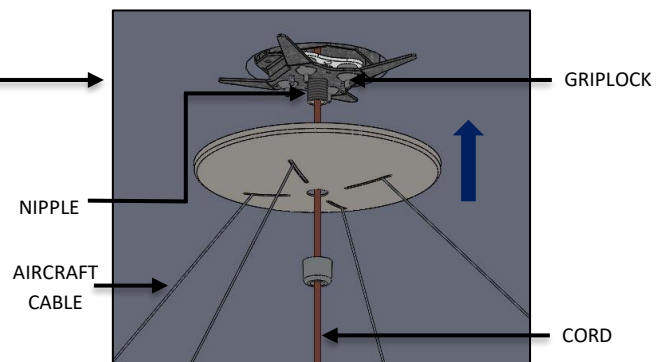

FIG. 19 – CANOPY DETAIL VIEW

WARNING:



Do not let the ARO LUMINAIRE hang free until all the AIRCRAFT CABLES are secured and evenly tensioned.

OCL Architectural Lighting

Phone: 314.863.1895

Fax: 314.863.3278

www.ocl.com

AO2-P1EU-INSTALLATION INSTRUCTIONS

4. Make all wire connections in the inside the junction box (by others) in accordance with the national electrical code and all applicable local and state codes. See wire diagram on sheet 05 and 06 and Instruction on how to shorten/install the cord on sheet 9.
5. Raise CANOPY and secure to ceiling by threading the FINIAL to the NIPPLE (MOUNTING BRACKET ASSEMBLY) until fully seated as shown in FIG. 20.

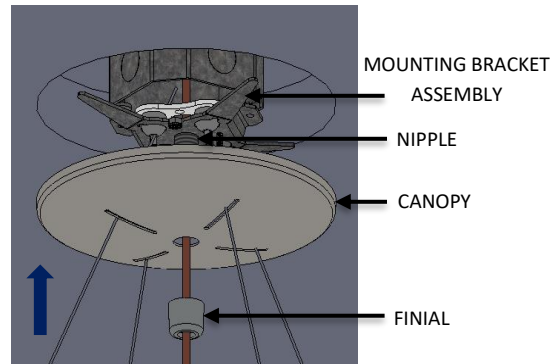

FIG. 20 - FINIAL INSTALLATION

6. Restore power to circuit the ARO Series pendant is connected to.
 - a. Test to see that the luminaire turns on after power is restored.
 - b. Contact OCL for any Luminaire troubleshooting if a problem occurs.

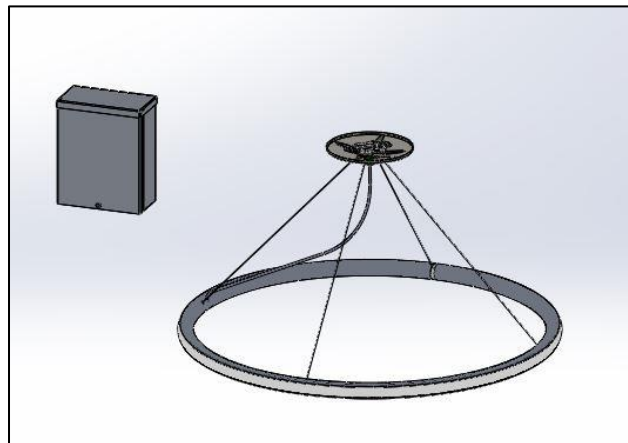

FIG. 21 - COMPLETED INSTALLATION OF
ARO PENDANT WITH P1EU HANGING
SYSTEM

OCL Architectural Lighting

Phone: 314.863.1895

Fax: 314.863.3278

www.ocl.com

CORD INSTALLATION INSTRUCTIONS

1. Strip off 1.00" of outer clear insulation exposing the outer metal braiding as shown in FIG. 22 below. **Be careful not to cut or damage the outer metal braiding.** Gently push braiding down to loosen the individual braids exposing the inner insulated wire as shown in FIG. 23 below.

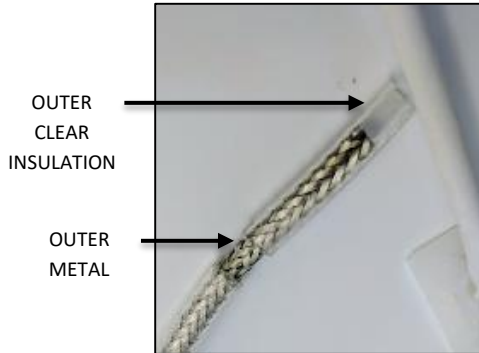

FIG. 22

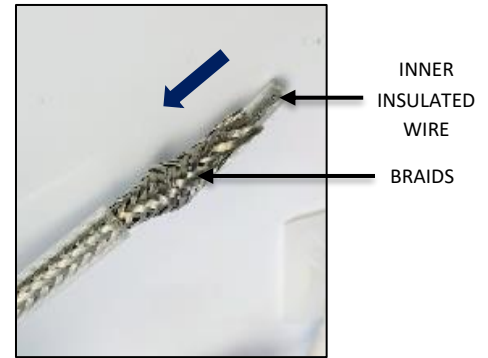

FIG. 23

2. Using a small pointed object, begin unweaving the exposed metal braiding as shown in FIG. 24 below. Position the unwoven metal strands on one side of the inner insulated wire and twist the individual strands together as shown in FIG. 25 below.

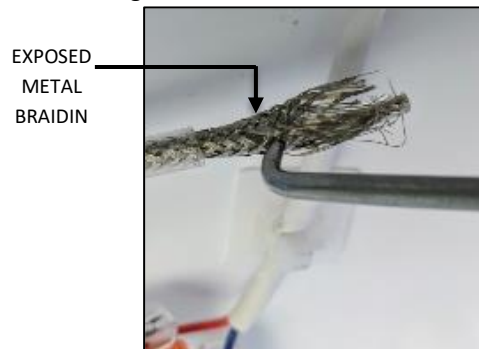

FIG. 24

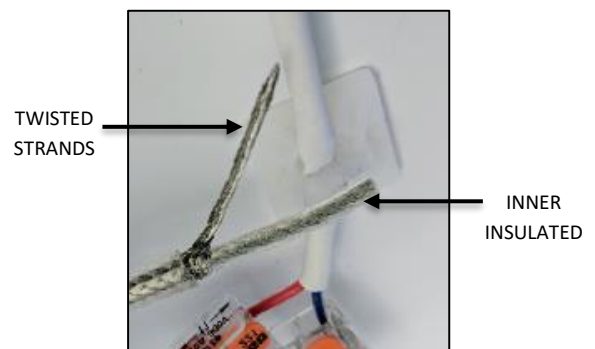

FIG. 25

3. Using electrical tape, insulate the twisted strands leaving 0.188" exposed for connections. Strip off 0.188" of the inner insulation as you normally would for 18AWG stranded core wire as shown in FIG. 26 below. Connect the inner insulated wire (+) to the positive 16 gauge or larger wire ran in step 5 at the hanging bracket and Connect the outer braiding (-) to the negative 16 gauge or larger wire ran in step 5 at the hanging bracket FIG. 27 below.

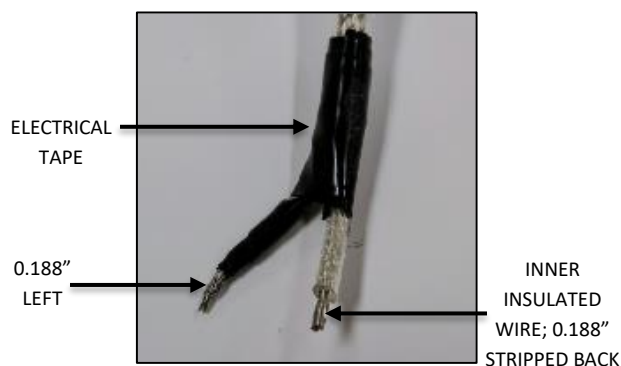

FIG. 26

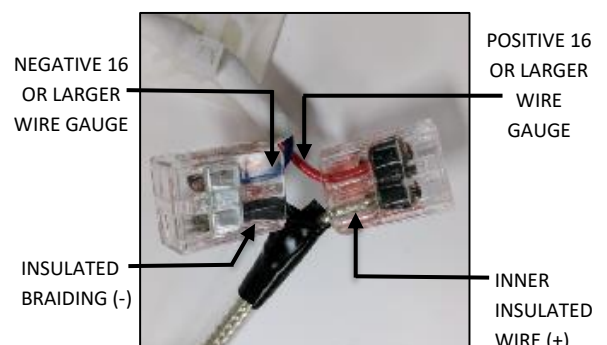

FIG. 27

OCL Architectural Lighting

Phone: 314.863.1895

Fax: 314.863.3278

www.ocl.com