

## INSTALLATION INSTRUCTIONS SCHOOL HOUSE PENDANT WITH P1AA HANGING SYSTEM

These instructions cover the SCHOOL HOUSE luminaire with the following options:

SERIES	HANGING SYSTEM	SIZE	LIGHT SOURCE	CONTROL	WIRE DIAGRAM
SC1 (SCHOOL HOUSE)	P1AA: PENDANT WITH A SINGLE CENTER STEM	14"	STATIC WHITE	0-10V DIM 1% (DM1)	WIRE DIAGRAM ON PAGE 4
		16"			
		18"			

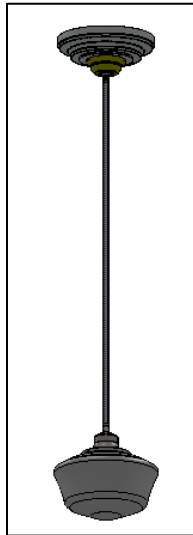

FIG. 1 - SC1-P1AA-XX-WG-XXX-LEDX\_XXK-UNV-DM1-XXX

### GENERAL NOTES:

1. PLEASE COMPLETELY READ THE INSTALLATION INSTRUCTIONS BEFORE STARTING INSTALLATION.
2. TURN OFF POWER TO CIRCUIT FIXTURE WHILE IT IS BEING INSTALLED
3. INSTALL IN ACCORDANCE WITH ALL LOCAL, STATE AND NATIONAL CODES CONSULT WITH A QUALIFIED ELECTRICIAN FOR PROPER INSTALLATION. DUAL CIRCUITING IS STANDARD ON MULTI-BALLAST FIXTURES.
4. CAREFULLY UNPACK ALL CONTENTS; SOME COMPONENTS MAY HAVE BEEN SHIPPED IN SEPARATE BOXES. MOST FIXTURES ARE SHIPPED PARTIALLY ASSEMBLED. SOME UNASSEMBLY MAY BE REQUIRED FOR INSTALLATION.
5. UPON RECEIPT OF THE FIXTURE, THOROUGHLY INSPECT FOR ANY FREIGHT DAMAGE. ANY DAMAGE SHOULD BE BROUGHT TO THE ATTENTION OF THE DELIVERY CARRIER.
6. THESE INSTRUCTIONS DO NOT CLAIM TO COVER ALL DETAILS OR VARIATIONS IN THE EQUIPMENT, PROCEDURE, OR PROCESS DESCRIBED; NOR DO THEY PROVIDE DIRECTIONS FOR MEETING EVERY POSSIBLE CONTINGENCY DURING INSTALLATION, OPERATION, OR MAINTENANCE. WHEN ADDITIONAL INFORMATION IS DESIRED TO SATISFY A PROBLEM NOT COVERED SUFFICIENTLY FOR USER'S PURPOSE, PLEASE CONTACT YOUR NEAREST REPRESENTATIVE.
7. THESE INSTRUCTIONS COVER VARIOUS SIZES OPTIONS. FIXTURE SHOWN IN INSTRUCTIONS MAY DIFFER FROM FIXTURE BEING INSTALLED. INSTALLATION STEPS ARE THE SAME HOWEVER.

**OCL Architectural Lighting**

Phone: 314.863.1895  
Fax: 314.863.3278  
www.ocl.com

# Table of Contents

**GENERAL INFORMATION:..... 3**

**MOUNTING:..... 4**

**SCHOOL HOUSE MOUNTING: ..... 4**

**GENERAL INFORMATION:**

You will receive the following with each SCHOOL HOUSE series pendant fixture:

1. LARGE CANOPY SUBASSEMBLY. (with CANOPY Pre-assembled as shown in FIG. 2)
2. STEM SUBASSEMBLY (Pre-assembled as shown in FIG. 3)
3. REFLECTOR SUBASSEMBLY (Pre-assembled as shown in FIG. 4)
4. GLASS SHADE (shown in FIG.5)
5. INSTALLATION INSTRUCTIONS (shown in FIG. 6) - Please completely read the install instructions before starting installation.

**WARNING: Examine all components for any damage before beginning installation.**  
**WARNING: This fixture should be installed by a licensed electrician only.**  
**WARNING: Be careful not to scratch or damage any finished parts.**

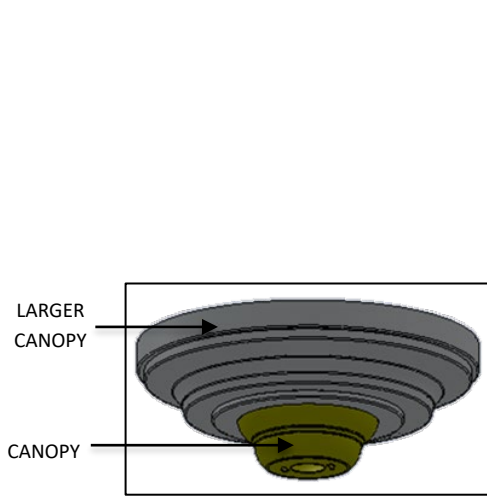

FIG.2 – LARGER CANOPY SUBASSEMBLY WITH CANOPY PREASSEMBLED

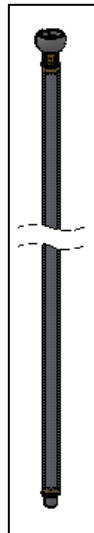

FIG.3 - STEM SUBASSEMBLY

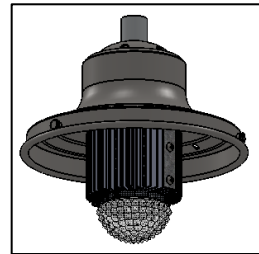

FIG.4 – REFLECTOR SUBASSEMBLY

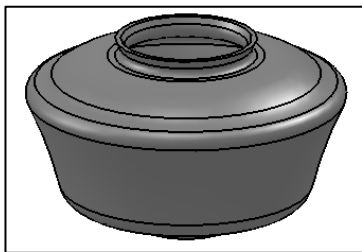

FIG.5 – GLASS SHADE

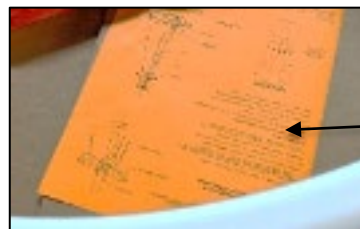

FIG.6 - INSTALLATION INSTRUCTIONS

INSTALLATION INSTRUCTIONS

## SC1-P1AA-XX-LED-INSTALLATION\_INSTRUCTIONS

### MOUNTING:

#### SCHOOL HOUSE MOUNTING:

1. Turn off Power. Separate the CANOPY from the LARGE CANOPY by twisting the CANOPY to unlock it from the MOUNTING BRACKET as shown in FIG. 7.
2. Attach the DRIVER PLATE to the MOUNTING SCREWS located inside the JUNCTION BOX (by other) as shown in FIG. 8.

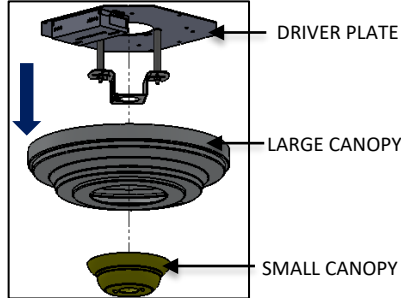

FIG. 7 – CANOPY DISASSEMBLY

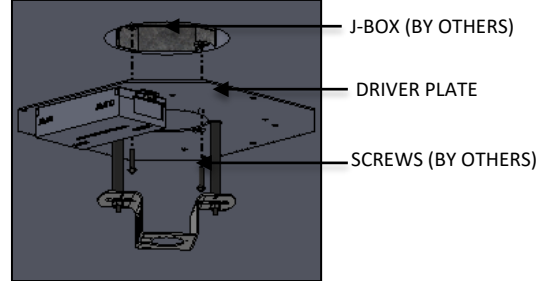

FIG. 8 – DRIVER PLATE INSTALLATION

3. Feed wires from the HOLDER through the CENTER STEM. Attach CENTER STEM onto the FITTER at the COUPLING as shown in FIG. 9.
4. Attach the CENTER STEM to the MOUNTING BRACKET by inserting the BALL into the opening inside the BRACKET as shown in FIG.10.

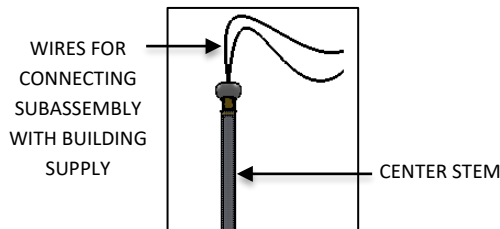

FIG. 9 – WIRE ROUTING THROUGH CENTER STEM

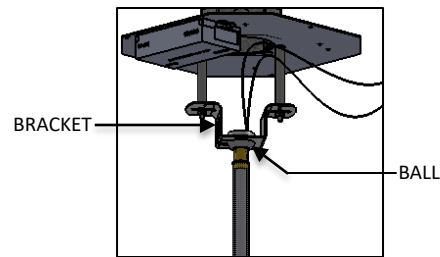

FIG. 10 – CENTER STEM INSTALLATION

5. make all wire connections in accordance with the NATIONAL ELECTRICAL CODES AND APPLICABLE LOCAL AND STATE CODES. See WIRE LABEL TABLE and WIRE DIAGRAM as shown in FIG.11 and 12.

WIRE DIAGRAM TABLE						
SERIES	HANGING SYSTEM	BODY SIZE	BODYLIGHT SOURCE	LED OUTPUT	CONTROL	WIRE DIAGRAM
SC1 (SCHOOLHOUSE)	P1AA: PENDANT WITH A SINGLE CENTER STEM	14"	STATIC WHITE	LED1	0-10V DIM 1% (DM1)	WIRE DIAGRAM ON PAGE 4
		16"		LED2		
		18"				

WIRE LABEL TABLE		
CONTROL	WIRE COLOR	LABEL
ALL	BLACK	LINE VOLTAGE
ALL	WHITE	NEUTRAL
ALL	GREEN	GROUND
DMI	PURPLE	0-10V (+)
DMI	GREY	0-10V (-)

FIG. 11 – WIRE LABEL TABLE

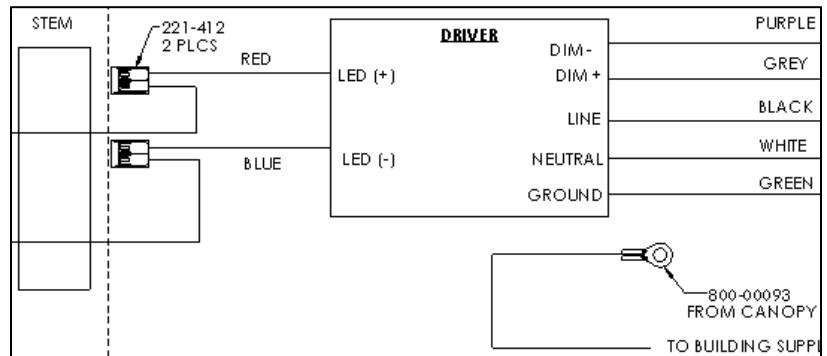

FIG. 12 – WIRE DIAGRAM

OCL Architectural Lighting

Phone: 314.863.1895

Fax: 314.863.3278

[www.ocl.com](http://www.ocl.com)

SC1-P1AA-XX-LED-INSTALLATION\_INSTRUCTIONS

6. Raise the CANOPIES to the ceiling and TWIST TO LOCK in place. Be careful not to scratch the finish of the FIXTURE SUBASSEMBLY as shown in FIG.13.
7. Assemble the REFLECTOR SUBASSEMBLY to the CENTER STEM at COUPLER and pass the wire through for connecting to the REFLECTOR SUBASSEMBLY as shown in FIG.14.

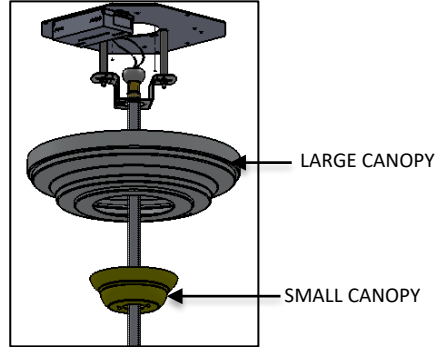

FIG. 13 – CANOPY INSTALLATION

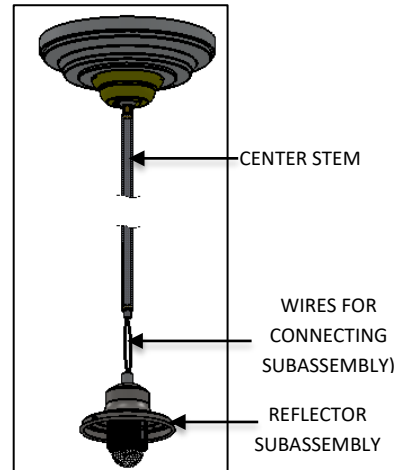

FIG. 14 – REFLECTOR INSTALLATION

8. Install the GLASS SHADE using the THUMB SCREWS provided as shown in FIG.15.

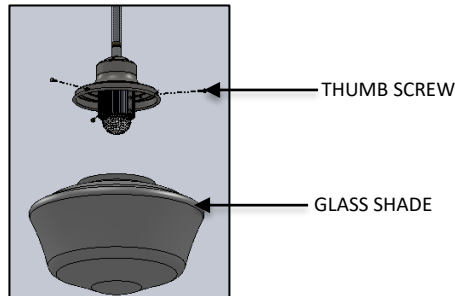

FIG. 15 – GLASS SHADE INSTALLATION

9. Restore power to circuit the SCHOOL HOUSE series pendant is connected to.
  - a. Test to see that the luminaire turns on after power is restored.
  - b. Contact OCL for any luminaire troubleshooting if a problem occurs.

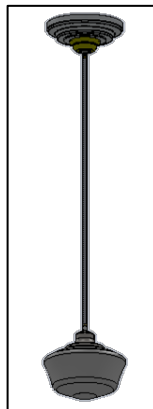

FIG. 16 - SC1-P1AA-XX-WG-XXX-LEDX\_XXK-UNV-DM1-XXX

OCL Architectural Lighting

Phone: 314.863.1895

Fax: 314.863.3278

[www.ocl.com](http://www.ocl.com)