



# Eau™

PENDANT

**FEATURES**

- AVAILABLE IN 80+ CRI AND 90+ CRI (R9>50)
- THE EAU WAS INSPIRED BY THE FLUIDITY OF FALLING DROPS OF WATER
- A SIMPLE GLASS GLOBE IS CAPPED OFF WITH A 0.064" THICK ALUMINUM SPINNING TO CELEBRATE THE CONNECTION BETWEEN THE GLASS AND THE SIMPLE CORD THAT SUSPENDS IT
- ALL OF THE ELEMENTS OF THIS FIXTURE FLOW TOGETHER WITH NO VISIBLE HARDWARE
- FEATURES HAND-BLOWN, OPAL WHITE GLASS WITH A MINIMUM WALL THICKNESS OF 0.150"



**CATALOG CODES**

<b>EU1</b>	<b>B</b>	<b>C</b>	<b>WG</b>	<b>E</b>	<b>F</b>	<b>UNV</b>	<b>H</b>	<b>DM1</b>	<b>J</b>
SERIES	HANGING SYSTEM	SIZE	DIFFUSER	FINISH	LIGHT SOURCE	VOLTAGE	OAH	CONTROL	OPTIONS

SPECIFY CATALOG CODE									
A	B		C	D		E			F
SERIES	HANGING SYSTEM		SIZE	DIFFUSER		FINISH			LIGHT SOURCE
 <b>EU1</b> EAU	<b>MOUNTING TYPE</b> <b>P1CB</b> PENDANT WITH SURFACE MOUNT CANOPY, SINGLE POWER CORD; MOUNTS TO 4X4 OCTAGON J-BOX (BY OTHERS)	<b>CORD COLOR</b> <b>B</b> BLACK POWER CORD <b>W</b> WHITE POWER CORD	<b>12</b>	<b>WG</b> WHITE GLASS		<b>POWDER COAT FINISHES</b> <b>BKP</b> BLACK <b>MWP</b> MATTE WHITE <b>BMP</b> BRASS METALLIC <b>SGP</b> STEEL GRAY <b>BNP</b> BRONZE <b>SMP</b> SILVER METALLIC <b>BTP</b> BLACK TEXTURED <b>SWP</b> SKY WHITE <b>GRP</b> GRAPHITE <b>WTP</b> WHITE TEXTURED <b>GLP</b> GOLDTASTIC			<b>LED OUTPUT</b> <b>LED1</b> <b>LED2</b> <b>LED3</b>
			<b>14</b>			<b>PREMIUM METAL FINISHES</b> <b>BAL</b> BRUSHED ALUMINUM			
			<b>16</b>						
		<b>VOLTAGE</b>		<b>OAH</b>	<b>CONTROL</b>		<b>OPTIONS</b>		
		<b>UNV 120-277</b>		<b>48</b> <b>100</b> <b>144</b>	<b>DM1 0-10V DIMMING 1%</b>		<b>ULD</b> DAMP LABEL <b>MOD</b> MODIFIED LUMINAIRE (CONTACT LOCAL REP)		
<b>SAMPLE CODE: EU1-P1CBW-14-WG-WTP-LED1/27K-UNV-48-DM1</b>									

**MODS, NOTES, & COMMENTS**

UP TO **74** LM/W

LUMENS AND WATTAGE CHART				
		12"	14"	16"
<b>LED1</b>	LUMENS DELIVERED	1080	1080	1080
	SYSTEM WATTAGE	14	14	14
<b>LED2</b>	LUMENS DELIVERED	1540	1540	1540
	SYSTEM WATTAGE	21	21	21
<b>LED3</b>	LUMENS DELIVERED	2100	2100	2100
	SYSTEM WATTAGE	29	29	29

This chart was created for a 35K color temp. Multiply by 0.95 for 27k color temp, 0.97 for 30k color temp, and 1.03 for 40k color temp. Wattage and lumen data approx. pending LM-79 testing. Values shown for 80+ CRI. For 90+ CRI lumens use 0.85 multiplier.

## HANGING SYSTEM

**PICB** PENDANT WITH SURFACE MOUNT CANOPY, SINGLE POWER CORD;  
MOUNTS TO 4X4 OCTAGON J-BOX (BY OTHERS)

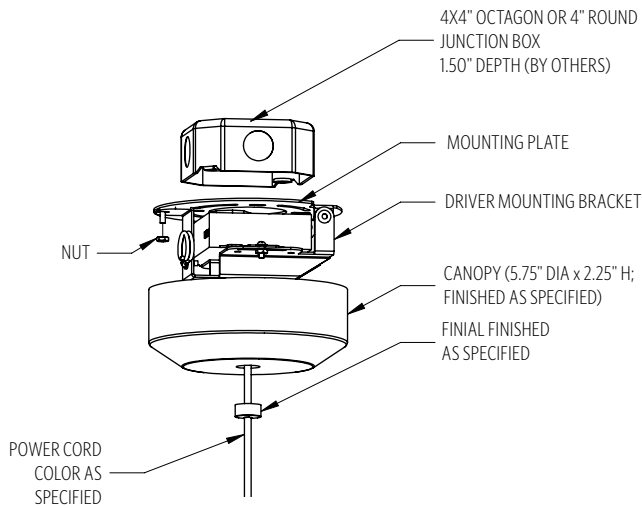

### MOUNTING INFORMATION CHART

LUMINAIRE SIZE	LUMINAIRE WEIGHT	MIN/MAX OAH
12"	9 LBS	24"/144"
14"	11 LBS	26"/144"
16"	12 LBS	28"/144"

PICB ships with one of three OAH's (48", 100" or 144") and is field adjustable to the desired height.

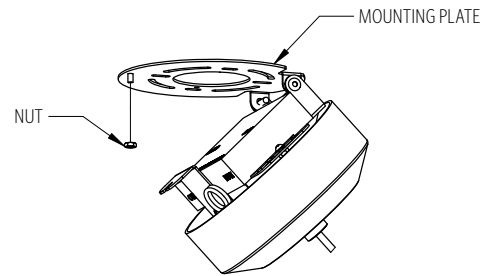

## SIZES

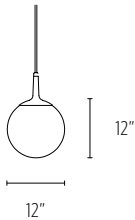

FIXTURE WEIGHT **9 LBS**

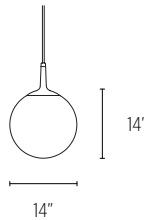

FIXTURE WEIGHT **11 LBS**

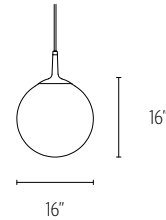

FIXTURE WEIGHT **12 LBS**

## DIFFUSER



**WG** WHITE GLASS

## FINISH

### METALLIC POWDER COAT FINISHES:



**SMP**  
SILVER



**GRP**  
GRAPHITE



**SGP**  
STEEL GRAY



**GLP**  
GOLDTASTIC



**BMP**  
BRASS



**BNP**  
BRONZE

### PREMIUM METAL FINISHES:



**BAL**  
BRUSHED ALUMINUM

### SOLID POWDER COAT FINISHES:



**SWP**  
SKY WHITE



**MWP**  
MATTE WHITE



**BKP**  
BLACK

### TEXTURED POWDER COAT FINISHES:



**BTP**  
BLACK TEXTURED



**WTP**  
WHITE TEXTURED

**RAL®, Pantone® or custom finishes are also available.**

These colors are for reference only. Please be aware that colors may vary per monitor. Contact your local rep for finish samples or with any questions.

## LIGHT SOURCE

### LUMENS AND WATTAGE CHART

		12"	14"	16"
<b>LED1</b>	LUMENS DELIVERED	1080	1080	1080
	SYSTEM WATTAGE	14	14	14
<b>LED2</b>	LUMENS DELIVERED	1540	1540	1540
	SYSTEM WATTAGE	21	21	21
<b>LED3</b>	LUMENS DELIVERED	2100	2100	2100
	SYSTEM WATTAGE	29	29	29

This chart was created for a 35K color temp. Multiply by 0.95 for 27k color temp, 0.97 for 30k color temp, and 1.03 for 40k color temp. Wattage and lumen data approx. pending LM-79 testing. Values shown for 80+ CRI. For 90+ CRI lumens use 0.85 multiplier.

### PHOTOMETRY:

FIXTURE:	EU1-PICA-16
COLOR TEMP #:	3500K
OUTPUT:	1500
EFFICACY:	74 LM/W
TEST REPORT:	TEST NO. 20014

For all available IES files, please visit our website at ocl.com.

STANDARD COLOR TEMPERATURE OPTIONS	CRI (RA)	
2700K	80+	90+
3000K	80+	90+
3500K	80+	90+
4000K	80+	90+

ZONE	LUMENS	% OF LUMINAIRE
0-30	147	7%
0-60	562	27%
0-90	1141	54%
90-180	955	46%

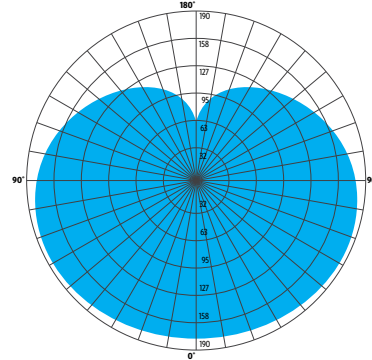

EU1

## CONTROL

### DM1 0-10V DIMMING DOWN TO 1%

- 0-10V DIMMING
- 1% MINIMUM DIMMING LEVEL
- ELECTRONIC DRIVER
- POWER FACTOR >0.9
- THD <20%
- MIN AMBIENT OPERATING TEMPERATURE = -31°F
- FIELD REPLACEABLE

## OPTIONS

### ULD DAMP LABEL LUMINAIRE

- MAY BE USED IN AN OUTDOOR AREA THAT IS PROTECTED FROM DIRECT CONTACT WITH WIND, RAIN, SNOW OR EXCESSIVE MOISTURE

### MOD MODIFIED LUMINAIRE

- LUMINAIRE IS MODIFIED FROM STANDARD OPTIONS; CONTACT LOCAL REP FOR MORE INFORMATION

## SPECIFICATIONS

### CONSTRUCTION

- FIXTURE IS SPUN, EXTRUDED, AND MACHINED ALUMINUM WITH A MINIMUM WALL THICKNESS OF 0.064"
- HAND-BLOWN, OPAL WHITE GLASS WITH A MINIMUM WALL THICKNESS OF 0.150"
- HANGING SYSTEMS USE STEEL OR ALUMINUM CANOPIES
- HARDWARE IS ZINC PLATED OR STAINLESS STEEL

### MOUNTING

- **PICB** MOUNTS TO 4X4" OCTAGON OR 4" ROUND J-BOX (BY OTHER)

### ELECTRICAL

- DIMMING ELECTRONIC DRIVER(S), COMES STANDARD WITH 0-10V DOWN TO 1%
- 0-10V DOWN TO 0.1% AND LUTRON ECOSYSTEM (LDE1) 1% ALSO AVAILABLE AS MODIFICATION
- BRIDGELUX COB
- LUMINAIRE CONNECTS TO BUILDING SUPPLY (120V-277V 50/60HZ) UNLESS DRIVERS ARE REMOTE

### LISTING

- ETL LISTED TO UL 1598 FOR DRY LOCATIONS; DAMP LOCATION LISTED IS OPTION

### WARRANTY

- 5 YEAR; ALL ELECTRICAL COMPONENTS RETAIN THE MANUFACTURER'S WARRANTY

The drawings and specifications and ideas, designs and arrangements represented on these drawings are and shall remain the property of The Original Cast Lighting (OCL Architectural Lighting) and no part thereof shall be copied, disclosed, to others or used in conjunction with any work or project other than the specified project for which they have been prepared and developed, without written consent of OCL. Visual contact with these plans or specifications shall constitute conclusive evidence of acceptance of these restrictions. All specifications and information subject to change without notice.