

INSTALLATION INSTRUCTIONS LEVO PENDANT WITH P1BX HANGING SYSTEM

These instructions cover the LEVO luminaire with the following options:

SERIES	HANGING SYSTEM	SIZE	LIGHT SOURCE	CONTROL	WIRE DIAGRAM
1. LE1 - LEVO	P1BX: PENDANT WITH EMERGENCY DRIVER IN SURFACE MOUNT CANOPY, SINGLE CENTER AIRCRAFT CABLE AND POWER CORD	10"	STATIC WHITE	DM1: 0-10V DIM 1% DM3: LUTRON HILUME ECOSYSTEM 1% (LDE1)	WIRE DIAGRAM ON PAGE 5

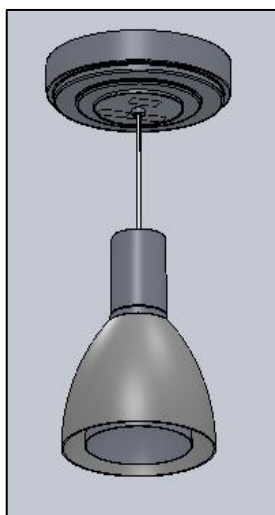

FIG. 1 - LE1-P1BX-10-XX-XXX-LEDX_XXK-UNV-XX-DM~

GENERAL NOTES:

1. PLEASE COMPLETELY READ THE INSTALL INSTRUCTIONS BEFORE STARTING INSTALLATION.
2. TURN OFF POWER TO CIRCUIT FIXTURE WHILE IT IS BEING INSTALLED.
3. INSTALL IN ACCORDANCE WITH ALL LOCAL, STATE AND NATIONAL CODES CONSULT WITH A QUALIFIED ELECTRICIAN FOR PROPER INSTALLATION.
4. CAREFULLY UNPACK ALL CONTENTS; SOME COMPONENTS MAY HAVE BEEN SHIPPED IN SEPARATE BOXES MOST FIXTURES ARE SHIPPED PARTIALLY ASSEMBLED. SOME UNASSEMBLY MAY BE REQUIRED FOR INSTALLATION.
5. FIXTURE POWER CORD WIRES ARE LOW- VOLTAGE. DO NOT CONNECT TO LINE VOLTAGE OR DAMAGE TO THE FIXTURE WILL OCCUR AND WARRANTY WILL BE VOIDED.
6. DO NOT LET THE LEVO LUMINAIRE HANG FREE UNTIL THE CABLE IS SECURED AND EVENLY TENSIONED.
7. DUE TO A CHANGE IN NEC SECTION 410.69 EFFECTIVE IN 2022, THE COLOR PINK WILL BE USED IN PLACE OF GRAY FOR 0-10V CONTROL. NOTE THAT EXISTING SYSTEMS AND FIXTURES MANUFACTURED PRIOR TO 2022 MAY STILL USE GRAY WIRE AS AN UNGROUNDED CONDUCTOR FOR 0-10V CONTROL. CARE SHOULD BE TAKEN WHEN WORKING ON EXISTING SYSTEMS.

OCL Architectural Lighting

Phone: 314.863.1895
Fax: 314.863.3278
www.ocl.com

Table of Contents

GENERAL INFORMATION:	3
MOUNTING:	4
LEVO MOUNTING [CANOPY]:	4

LE1-P1BX-INSTALLATION-INSTRUCTIONS

GENERAL INFORMATION:

You will receive the following with each LEVO series pendant fixture:

1. LEVO LUMINAIRE with CORD attached. (Pre-assembled as shown in FIG. 2)
2. INSTALLATION INSTRUCTIONS (shown in FIG. 3) - Please completely read the install instructions before starting installation.
3. RED BAG (shown in FIG. 3) contains below following items
 - a. CANOPY SUBASSEMBLY (as shown in FIG. 4)
 - b. WALL PLATE (as shown in FIG. 5)
 - c. STRAIN RELIEF (as shown in FIG. 6)

WARNING: Examine all components for any damage before beginning installation.

WARNING: This fixture should be installed by a licensed electrician only.

WARNING: Be careful not to scratch or damage any finished parts.

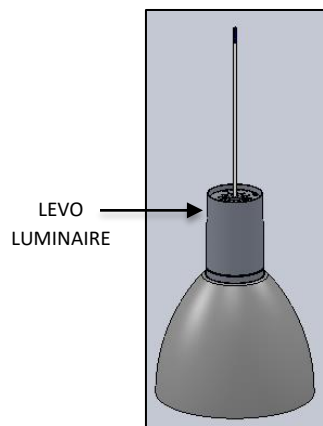

FIG. 2 LEVO LUMINAIRE (PRE-ASSEMBLED)

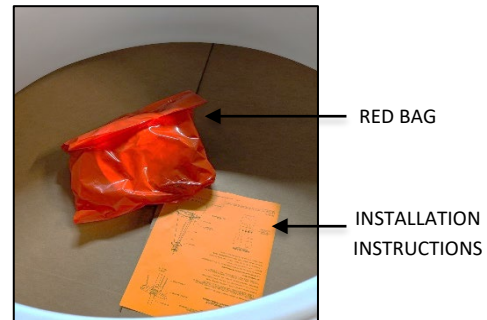

FIG. 3 RED BAG AND INSTALLATION INSTRUCTIONS

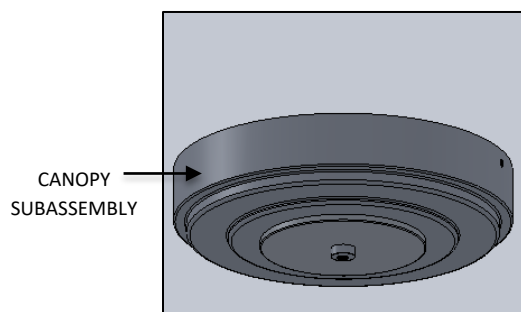

FIG. 4 - CANOPY SUBASSEMBLY

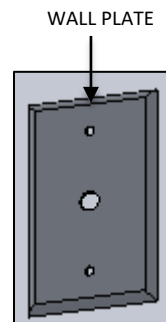

FIG. 5 - WALL PLATE

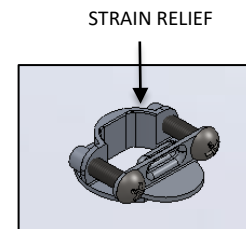

FIG. 6 - STRAIN RELIEF

OCL Architectural Lighting

Phone: 314.863.1895

Fax: 314.863.3278

www.ocl.com

LE1-P1BX-INSTALLATION-INSTRUCTIONS

MOUNTING:

LEVO MOUNTING [CANOPY]:

1. Turn off power to circuit fixture while it is being installed.
2. Unscrew the CANOPY FINIAL and remove CANOPIES. Be careful not to scratch finish as shown in FIG. 7.
3. Attach MOUNTING PLATE to JUNCTION BOX (by other) as shown below in FIG. 8.

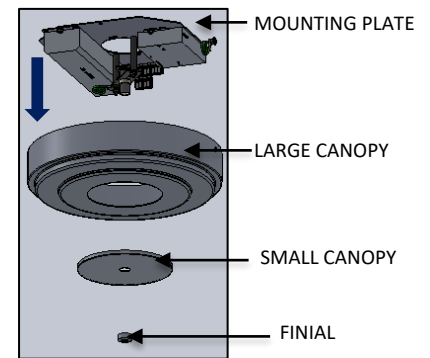

FIG. 7 – CANOPY DIS-ASSEMBLY

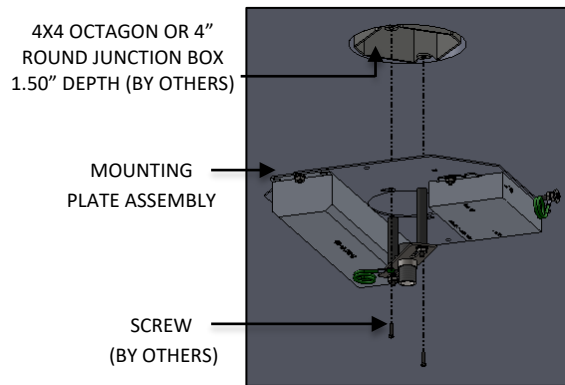

FIG. 8 – MOUNTING PLATE ASSEMBLY INSTALLATION

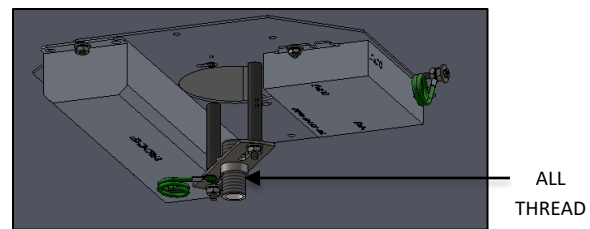

FIG. 9 – MOUNTING PLATE ASSEMBLED VIEW

4. Raise the LEVO FIXTURE and pass the CORD through CANOPY FINIAL, CANOPY AND ALL THREAD. ADJUST FIXTURE DROP TO DESIRED HEIGHT as shown below in FIG. 10. Mark cord with marker inside of DRIVER MOUNTING BRACKET as shown below in FIG. 11. Trim off excess cord leaving minimum of 8.00" past the top of the DRIVER MOUNTING BRACKET all thread as shown below in FIG. 12.

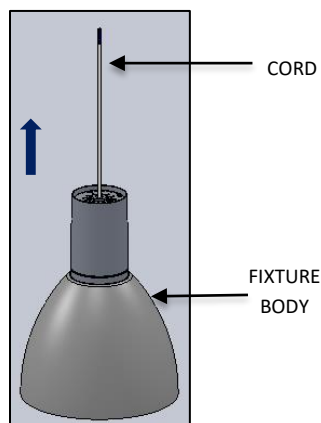

FIG. 10 – FIXTURE INSTALLATION

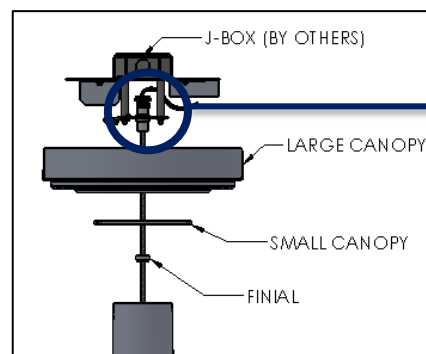

FIG. 11 -CORD INSTALLATION

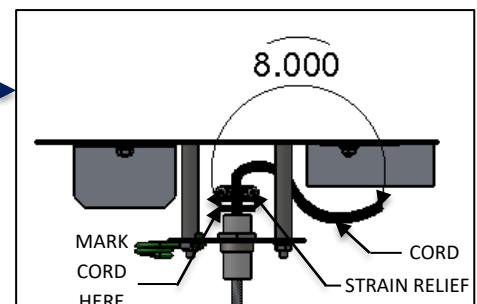

FIG.12 – DETAIL SHOWING CORD TRIM INFORMATION

OCL Architectural Lighting

Phone: 314.863.1895

Fax: 314.863.3278

www.ocl.com

LE1-P1BX-INSTALLATION-INSTRUCTIONS

- Insert cord through the strain relief and tighten two screws on the strain relief above hanging bracket where marked. If screws are not properly tightened cord could slip through the strain relief, causing the fixture to fall as shown in FIG. 13.

WARNING:



Do not let the LEVO LUMINAIRE hang free until CABLE is secured and evenly tensioned.

- Make wire connections between Building Supply, Driver and fixture cord inside the junction box (by others) in accordance with the NATIONAL ELECTRICAL CODE and all applicable LOCAL AND STATE CODES. See WIRE LABEL TABLE and WIRE DIAGRAM shown in FIG. 14 and FIG. 15 for wire connections.

TIGHTEN SCREWS ALL THE WAY

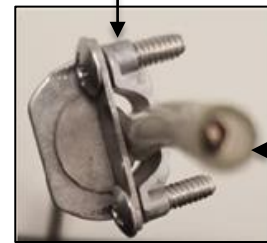

FIG. 13 – STRAIN RELIEF WITH CORD INSERTED

WIRE DIAGRAM TABLE						
SERIES	HANGING SYSTEM	BODY SIZE	BODYLIGHT SOURCE	LED OUTPUT	CONTROL	WIRE DIAGRAM
LE1 LEVO	P1BX	10"	STATIC WHITE	LED1 LED2	DM1: 0-10V DIM 1% DM3: LUTRON HILUME ECOSYSTEM 1% (LDE1)	WIRE DIAGRAM ON PAGE 5

WIRE LABEL TABLE		
CONTROL	WIRE COLOR	LABEL
ALL	RED(CORD)	LED(+)
ALL	BLUE(CORD)	LED(-)
ALL	GREEN(CORD)	GROUND
ALL	BLACK	LINE VOLTAGE
ALL	WHITE	NEUTRAL
ALL	GREEN(DRIVER)	GROUND
ALL	RED/WHITE	LED(+)
ALL	BLUE/WHITE	LED(-)
ALL	RED/BLACK	TEST(+)
ALL	RED/WHITE	TEST(-)
DM1	PURPLE	0-10V(+)
DM1	PINK	0-10V(-)
DM3	PURPLE	E2
DM3	PINK	E1

FIG. 14 – WIRE LABEL INFORMATION

NOTE: Below captured WIRE DIAGRAM for Reference only. Please refer to the installation instructions from the manufacturer of the LED EMERGENCY DRIVER for complete wiring diagram/specifications.

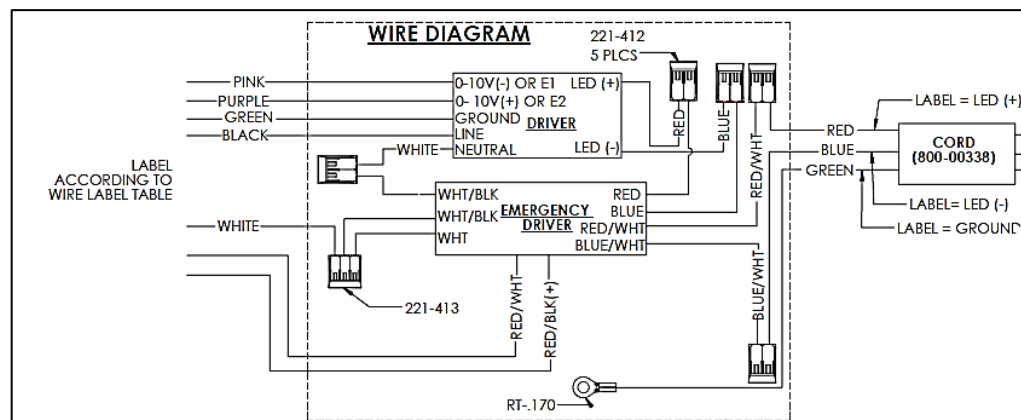

SEE GENERAL NOTE 7 ON PAGE 1

FIG. 15 – WIRE DIAGRAM

OCL Architectural Lighting

Phone: 314.863.1895
Fax: 314.863.3278

www.oclighting.com

LE1-P1BX-INSTALLATION-INSTRUCTIONS

7. Swing DRIVER MOUNTING BRACKET back over and secure it with KNURLED NUT removed in step 2.
8. Raise CANOPY and secure to ceiling by threading the FINIAL as shown below in FIG. 16 to the NIPPLE (available in MOUNTING BRACKET ASSEMBLY).

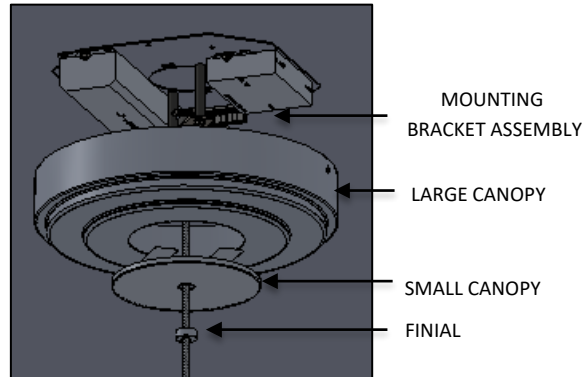
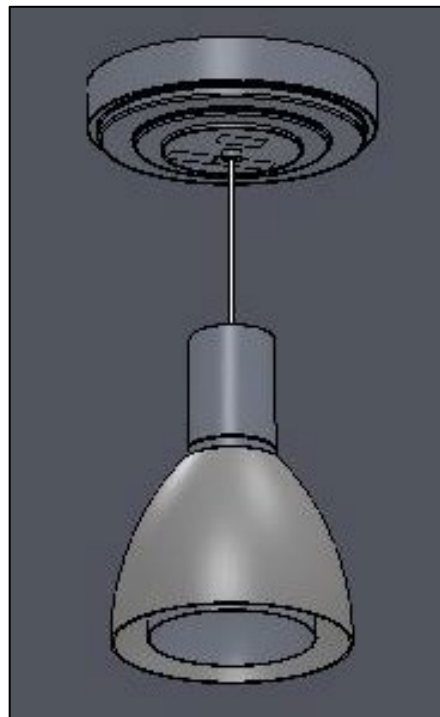

FIG. 16 – FINIAL INSTALLATION

9. Restore power to circuit the LEVO series pendant is connected to.
 - a. Test to see that the luminaire turns on after power is restored.
 - b. Contact OCL for any luminaire troubleshooting if a problem occurs.

FIG. 17 - COMPLETED INSTALLATION OF LEVO
PENDANT WITH P1BX HANGING SYSTEM

OCL Architectural Lighting

Phone: 314.863.1895

Fax: 314.863.3278

www.ocl.com