

INSTALLATION INSTRUCTIONS

FABRIC PENDANT WITH P1AA HANGING SYSTEM (INCANDESCENT)

These Instructions cover the FABRIC luminaire with the following options:

SERIES	HANGING SYSTEM	SIZE	LIGHT SOURCE	WIRE DIAGRAM
1. FB1(FABRIC ROUND)	P1AA: PENDANT WITH A SINGLE CENTER STEM	24"	INCANDESCENT	WIRE DIAGRAM ON PAGE 5
2. FB2(FABRIC SQUARE)		36"		
		48"		

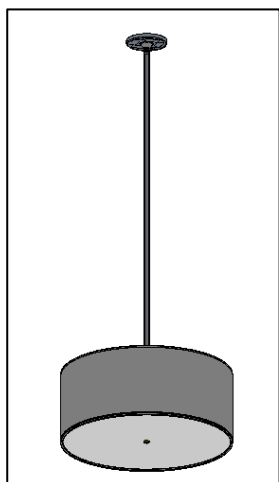

FIG. 1 - FB1-P1AA-24-XX_GC-XXX-3IN60-UNV-XXX
(SHOWN)

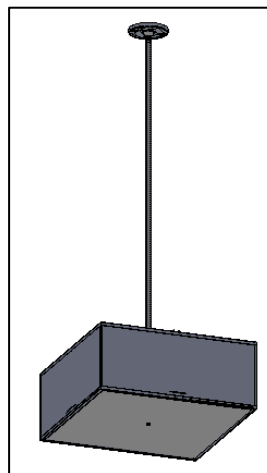

FIG. 2 – FB2-P1AA-24-XX_GC-XXX-3IN60-UNV-XXX
(SHOWN)

GENERAL NOTES:

1. PLEASE COMPLETELY READ THE INSTALLATION INSTRUCTIONS BEFORE STARTING INSTALLATION.
2. INSTALL IN ACCORDANCE WITH ALL LOCAL, STATE AND NATIONAL CODES CONSULT WITH A QUALIFIED ELECTRICIAN FOR PROPER INSTALLATION. DUAL CIRCUITING IS STANDARD ON MULTI-BALLAST FIXTURES.
3. CAREFULLY UNPACK ALL CONTENTS; SOME COMPONENTS MAY HAVE BEEN SHIPPED IN SEPARATE BOXES. MOST FIXTURES ARE SHIPPED PARTIALLY ASSEMBLED. SOME UNASSEMBLY MAY BE REQUIRED FOR INSTALLATION.
4. UPON RECEIPT OF THE FIXTURE, THOROUGHLY INSPECT FOR ANY FREIGHT DAMAGE. ANY DAMAGE SHOULD BE BROUGHT TO THE ATTENTION OF THE DELIVERY CARRIER.
5. THESE INSTRUCTIONS DO NOT CLAIM TO COVER ALL DETAILS OR VARIATIONS IN THE EQUIPMENT, PROCEDURE, OR PROCESS DESCRIBED; NOR DO THEY PROVIDE DIRECTIONS FOR MEETING EVERY POSSIBLE CONTINGENCY DURING INSTALLATION, OPERATION, OR MAINTENANCE. WHEN ADDITIONAL INFORMATION IS DESIRED TO SATISFY A PROBLEM NOT COVERED SUFFICIENTLY FOR USER'S PURPOSE, PLEASE CONTACT YOUR NEAREST REPRESENTATIVE.
6. THESE INSTRUCTIONS COVER VARIOUS SIZES OPTIONS. FIXTURE SHOWN IN INSTRUCTIONS MAY DIFFER FROM FIXTURE BEING INSTALLED. INSTALLATION STEPS ARE THE SAME HOWEVER.

OCL Architectural Lighting

Phone: 314.863.1895
Fax: 314.863.3278
www.ocl.com

Table of Contents

GENERAL INFORMATION:	3
MOUNTING:	4
FABRIC MOUNTING:	4
WIRE DIAGRAM:	5

FB1_FB2-P1AA-INCANDESCENT-INSTALLATION INSTRUCTIONS

GENERAL INFORMATION:

You will receive the following with each FABRIC Series Pendant fixture:

1. CANOPY AND STEM SUBASSEMBLY. (Pre-assembled as shown in FIG. 3)
2. MOUNTING STRAP (shown in FIG. 4)
3. BOTTOM STEM ASSEMBLY (Pre-assembled as shown in FIG. 5)
4. INSTALLATION INSTRUCTIONS (shown in FIG. 6) - Please completely read the install instructions before starting installation.
5. RED BAG (shown in FIG. 6) contains below following item
 - a. SCREWS (shown in FIG. 7)
6. REFLECTOR SUBASSEMBLY (Pre-assembled as shown in FIG. 8)
7. DIFFUSER (shown in FIG. 9)
8. FABRIC SHADE (shown in FIG. 10)

WARNING: Examine all components for any damage before beginning installation.

WARNING: This fixture should be installed by a licensed electrician only.

WARNING: Be careful not to scratch or damage any finished parts.

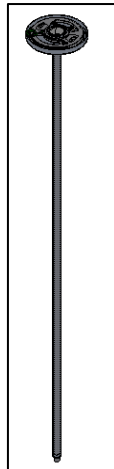

FIG. 3 - CANOPY AND
STEM SUBASSEMBLY

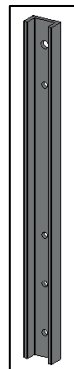

FIG. 4 - MOUNTING
STRAP (4 QTY)

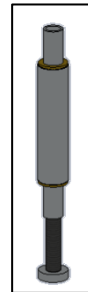

FIG. 5 - BOTTOM
STEM ASSEMBLY



RED BAG
INSTALLATION
INSTRUCTIONS

FIG. 6 - RED BAG AND
INSTALLATION INSTRUCTIONS

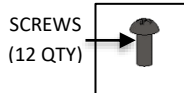

FIG. 7 - REDBAG
CONTENTS

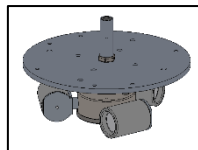

FIG. 8 - REFLECTOR
SUBASSEMBLY

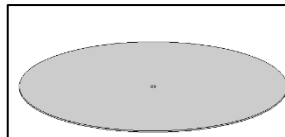

FIG. 9 - DIFFUSER

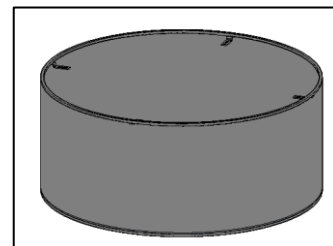

FIG. 10 - FABRIC SHADE

OCL Architectural Lighting

Phone: 314.863.1895

Fax: 314.863.3278

www.ocl.com

FB1_FB2-P1AA-INCANDESCENT-INSTALLATION INSTRUCTIONS

MOUNTING:

FABRIC MOUNTING:

1. Turn off Power.
2. Attach BOTTOM STEM to REFLECTOR SUBASSEMBLY as shown in FIG.11 at the HICKEY/COUPLER which is preassembled inside of REFLECTOR SUBASSEMBLY as shown in FIG. 12.

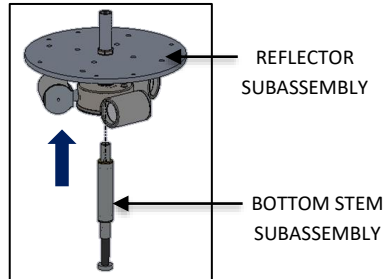

FIG. 11 – BOTTOM STEM INSTALLATION

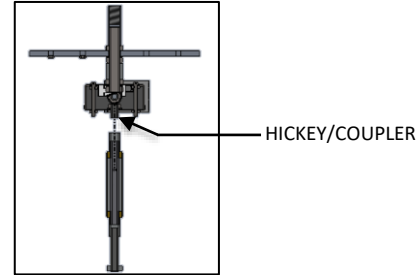

FIG. 12 – SECTION VIEW SHOWING
BOTTOM STEM INSTALLATION

3. Assemble MOUNTING STRAPS to the REFLECTOR SUBASSEMBLY by SCREWS provided as shown in FIG. 13.
4. Attach the STEMS based upon the length required using COUPLER and SHOULDER as shown in FIG. 14.
Use thread locker on all stem connections and fully tighten stem sections together.

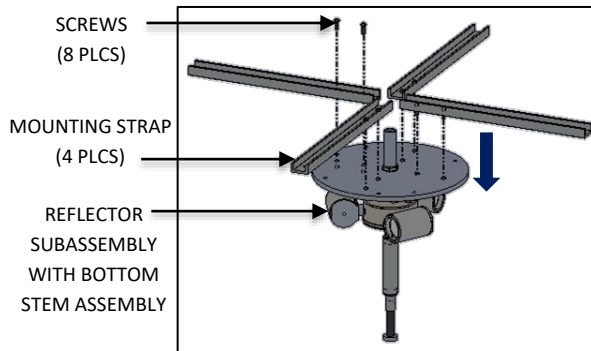

FIG. 13 – MOUNTING STRAPS
INSTALLATION

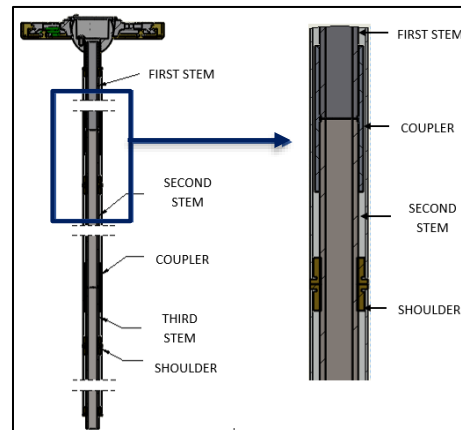

FIG. 14 – DETAIL SHOWING STEM
INSTALLATION

5. Feed the WIRES through the CANOPY and STEM SUBASSEMBLY and pull it from the top to give connection to BUILDING SUPPLY as shown below in FIG. 15 and then assemble STEM ASSEMBLY to REFLECTOR SUBASSEMBLY

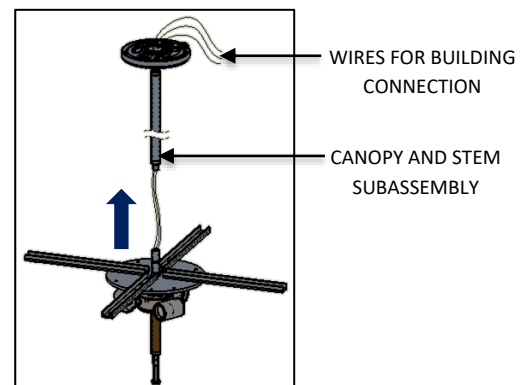

FIG. 15 – CANOPY AND STEM
INSTALLATION

OCL Architectural Lighting

Phone: 314.863.1895

Fax: 314.863.3278

www.ocl.com

FB1_FB2-P1AA-INCANDESCENT-INSTALLATION INSTRUCTIONS

6. Loosen CANOPY and slide down STEM by rotating the CANOPY 90 degrees counterclockwise as shown in FIG.16. Be careful not to damage the finish of the fixture.
7. Mount the assembly to the JUNCTION BOX (by others) as shown below in FIG. 17. If the fixture has a SAFETY CABLE, attach this to a structural member.

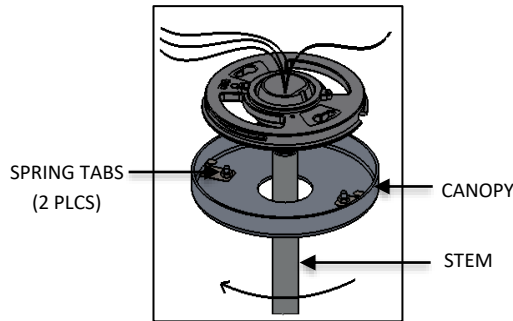
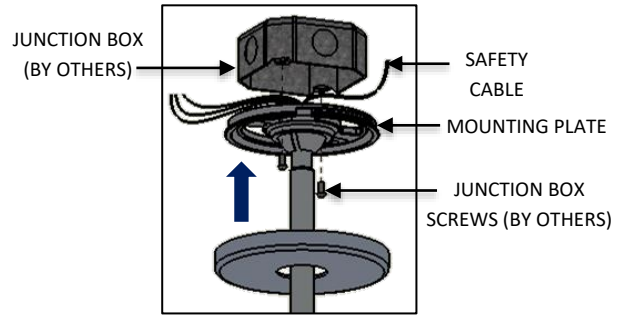

FIG. 16 – CANOPY DISASSEMBLY

FIG. 17 – MOUNTING PLATE
INSTALLATION TO JUNCTION BOX

8. Make all wire connections in accordance with the NATIONAL ELECTRICAL CODE and all applicable LOCAL AND STATE CODES inside the JUNCTION BOX (BY OTHERS). See WIRE DIAGRAM and WIRE LABEL TABLE below as shown in FIG. 18 and 19 for wire connections.

SERIES	HANGING SYSTEM	BODY SIZE	BODYLIGHT SOURCE	WIRE DIAGRAM
1. FB1(FABRIC ROUND)	P1AA: PENDANT WITH A SINGLE CENTER STEM	24"	INCANDESCENT	WIRE DIAGRAM ON PAGE 5
2. FB2(FABRIC SQUARE)		36"		
		48"		

WIRE DIAGRAM:

WIRE LABEL TABLE		
CONTROL	WIRE COLOR	LABEL
ALL	BLACK	LINE VOLTAGE
ALL	WHITE	NEUTRAL
ALL	GREEN	GROUND

FIG. 18 – WIRE LABEL TABLE

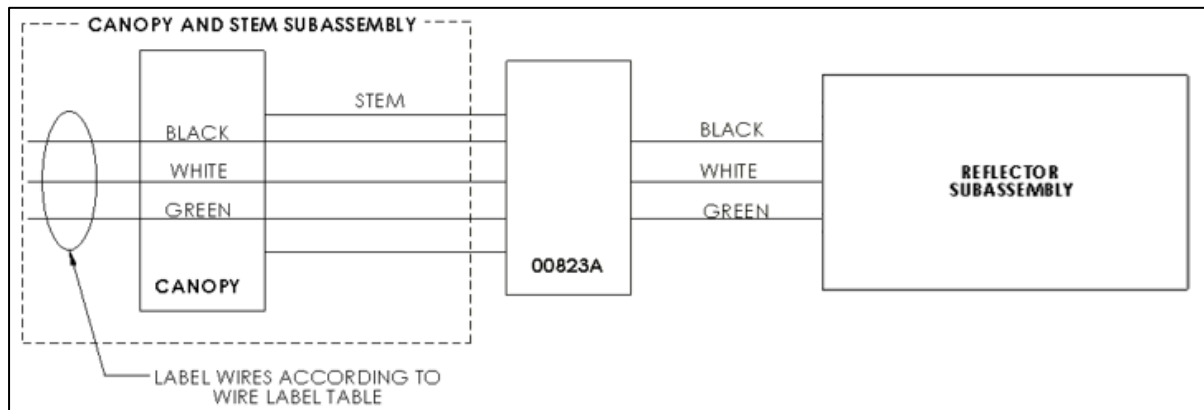

FIG. 19 – WIRE DIAGRAM

OCL Architectural Lighting

Phone: 314.863.1895

Fax: 314.863.3278

www.oclighting.com

FB1_FB2-P1AA-INCANDESCENT-INSTALLATION INSTRUCTIONS

9. Raise the CANOPY and tighten onto the MOUNTING BRACKET by lining the SPRING TABS (shown in FIG.15) up the NOTCHES in the MOUNTING BRACKET and rotating 90 degrees clockwise as shown in FIG. 20.
10. Insert DIFFUSER into FABRIC SHADE by sliding in at an angle through the bottom (side with no brackets as shown in FIG.21). Be careful not to damage the fabric. DIFFUSER will rest on the frame of fabric shade.

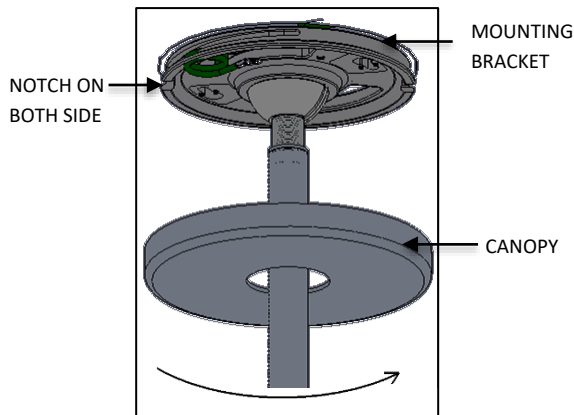

FIG. 20 – CANOPY INSTALLATION

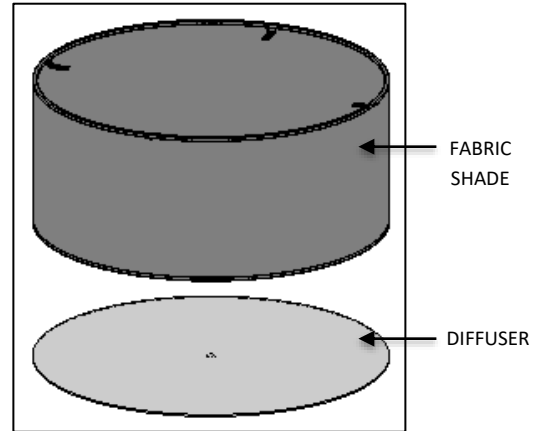

FIG. 21 – DIFFUSER INSTALLATION

11. Unscrew the BOTTOM FINIAL from BOTTOM STEM ASSEMBLY. Attach FABRIC and DIFFUSER to the MOUNTING STRAPS and secure with the SCREWS provided as shown in FIG. 22. Make sure the center stem is lined up with the hole in the DIFFUSER and attach to BOTTOM FINIAL as shown below in FIG. 23.

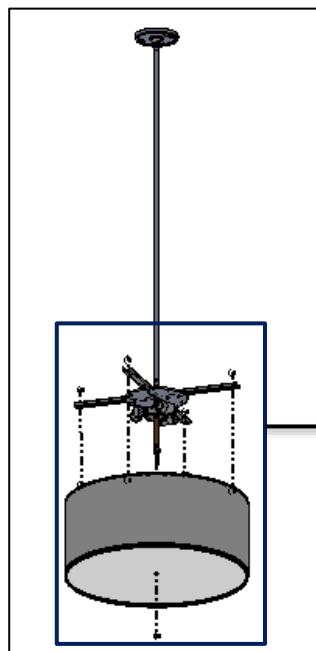

FIG. 22 – FABRIC SHADE AND DIFFUSER INSTALLATION

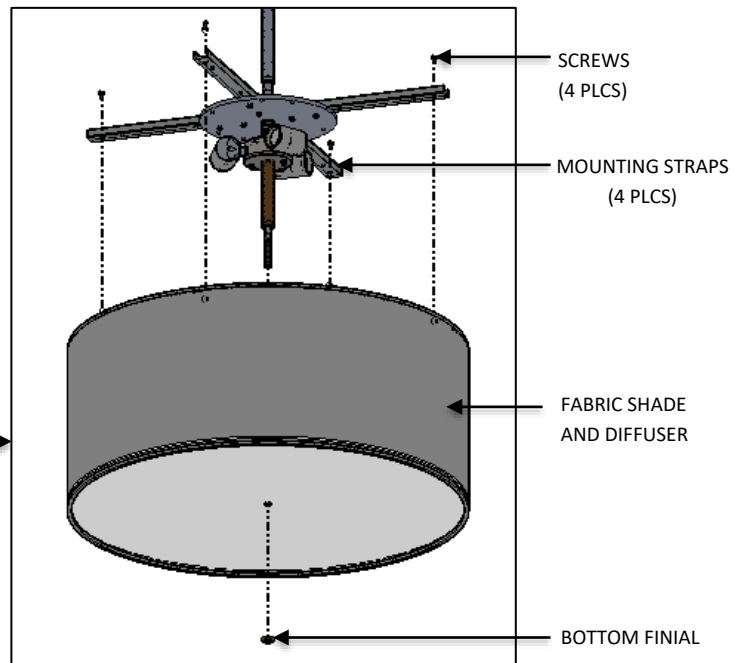

FIG. 23 – DETAIL VIEW SHOWING FABRIC SHADE AND DIFFUSER INSTALLATION

FB1_FB2-P1AA-INCANDESCENT-INSTALLATION INSTRUCTIONS

12. Restore power to circuit the FABRIC series pendant is connected to.
- Test to see that the luminaire turns on after power is restored.
 - Contact OCL for any luminaire troubleshooting if a problem occurs.



FIG. 24 - COMPLETED INSTALLATION OF FABRIC
PENDANT WITH P1AA HANGING SYSTEM
FB1-P1AA-24-XX_GC-XXX-3IN60-UNV-XXX (SHOWN)

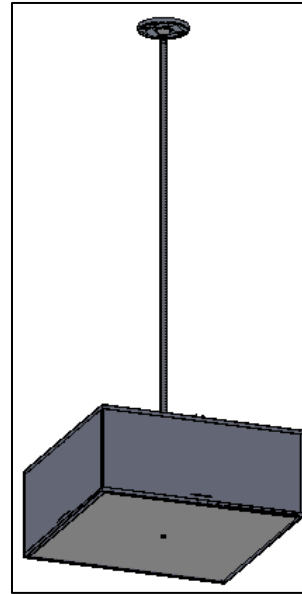

FIG. 25 - COMPLETED INSTALLATION OF FABRIC
PENDANT WITH P1AA HANGING SYSTEM
FB2-P1AA-24-XX_GC-XXX-3IN60-UNV-XXX (SHOWN)