

## INSTALLATION INSTRUCTIONS

### EAU PENDANT WITH P1CBX HANGING SYSTEM

These instructions cover the EAU luminaire with the following options:

SERIES	HANGING SYSTEM	SIZE	LIGHT SOURCE	CONTROL	WIRE DIAGRAM
EU1 (EAU)	P1CBX: PENDANT WITH SURFACE MOUNT CANOPY, SINGLE WHITE (P1CBW) OR BLACK (P1CBB) POWER CORD; MOUNTS TO 4X4 OCTAGON J-BOX (BY OTHERS)	12" 14" 16"	STATIC WHITE	DM1: 0-10V DIM 1%	WIRE DIAGRAM ON PAGE 5

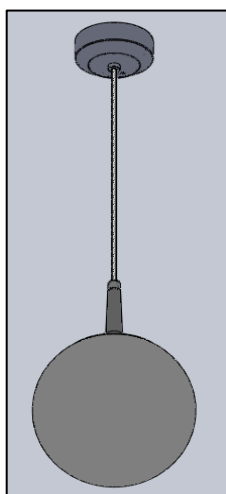

FIG. 1 - EU1-P1CBX-12-WG-XXX-LEDX\_XXK-UNV-XXX-DM1-XXX

#### GENERAL NOTES:

1. PLEASE COMPLETELY READ THE INSTALLATION INSTRUCTIONS BEFORE STARTING INSTALLATION.
2. TURN OFF POWER TO CIRCUIT FIXTURE WHILE IT IS BEING INSTALLED.
3. INSTALL IN ACCORDANCE WITH ALL LOCAL, STATE AND NATIONAL CODES CONSULT WITH A QUALIFIED ELECTRICIAN FOR PROPER INSTALLATION.
4. CAREFULLY UNPACK ALL CONTENTS; SOME COMPONENTS MAY HAVE BEEN SHIPPED IN SEPARATE BOXES MOST FIXTURES ARE SHIPPED PARTIALLY ASSEMBLED. SOME UNASSEMBLY MAY BE REQUIRED FOR INSTALLATION.
5. FIXTURE POWER CORD WIRES ARE LOW- VOLTAGE. DO NOT CONNECT TO LINE VOLTAGE OR DAMAGE TO THE FIXTURE WILL OCCUR AND WARRANTY WILL BE VOIDED.
6. DO NOT LET THE EAU LUMINAIRE HANG FREE UNTIL THE CABLE IS SECURED AND EVENLY TENSIONED.
7. DUE TO A CHANGE IN NEC SECTION 410.69 EFFECTIVE IN 2022, THE COLOR PINK WILL BE USED IN PLACE OF GRAY FOR 0-10V CONTROL. NOTE THAT EXISTING SYSTEMS AND FIXTURES MANUFACTURED PRIOR TO 2022 MAY STILL USE GRAY WIRE AS AN UNGROUNDED CONDUCTOR FOR 0-10V CONTROL. CARE SHOULD BE TAKEN WHEN WORKING ON EXISTING SYSTEMS.

**OCL Architectural Lighting**

Phone: 314.863.1895

Fax: 314.863.3278

www.ocl.com

## Table of Contents

<b>GENERAL INFORMATION:</b> .....	<b>3</b>
<b>MOUNTING:</b> .....	<b>4</b>
<b>EAU MOUNTING [CANOPY]:</b> .....	<b>4</b>
<b>WIRE DIAGRAM:</b> .....	<b>5</b>

## EU1-P1CBX-LED-INSTALLATION-INSTRUCTIONS

### GENERAL INFORMATION:

You will receive the following with each EAU series pendant fixture:

1. EAU LUMINAIRE with CORD attached. (Pre-assembled as shown in FIG. 2)
2. INSTALLATION INSTRUCTIONS (shown in FIG. 3) - Please completely read the install instructions before starting installation.
3. RED BAG (shown in FIG. 3) contains below following items:
  - a. CANOPY SUBASSEMBLY (as shown in FIG. 4)
  - b. STRAIN RELIEF (as shown in FIG. 5)

**WARNING: Examine all components for any damage before beginning installation.**

**WARNING: This fixture should be installed by a licensed electrician only.**

**WARNING: Be careful not to scratch or damage any finished parts.**

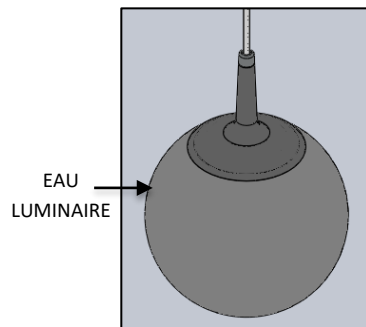

FIG.2 EAU LUMINAIRE  
(PRE-ASSEMBLED)

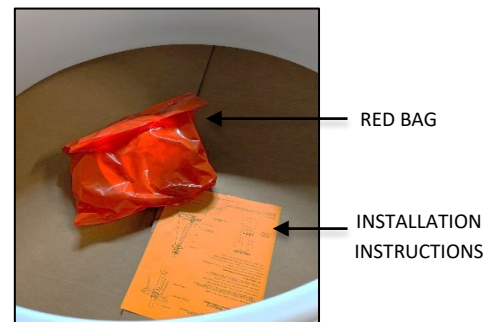

FIG.3 RED BAG AND  
INSTALLATION INSTRUCTIONS

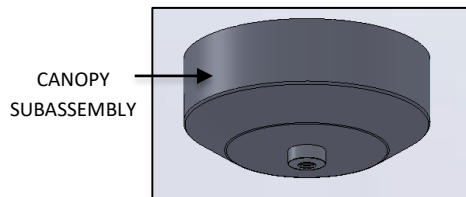

FIG. 4 - CANOPY SUBASSEMBLY

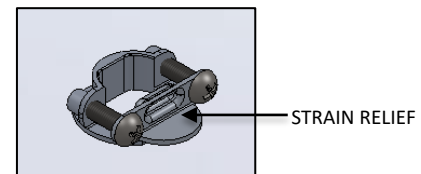

FIG. 5 - STRAIN RELIEF

## EU1-P1CBX-LED-INSTALLATION-INSTRUCTIONS

### MOUNTING:

#### EAU MOUNTING [CANOPY]:

1. Loosen the CANOPY FINIAL and remove CANOPY. Be careful not to scratch finish as shown in FIG. 6.
2. Unscrew the KNURLED NUT securing MOUNTING PLATE to driver MOUNTING BRACKET. Swing driver mounting bracket down and out of the way as shown below in FIG. 7.

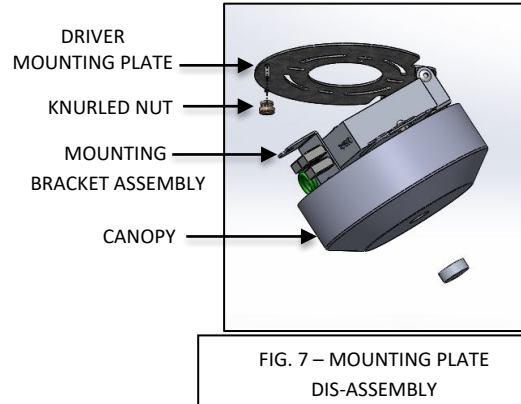
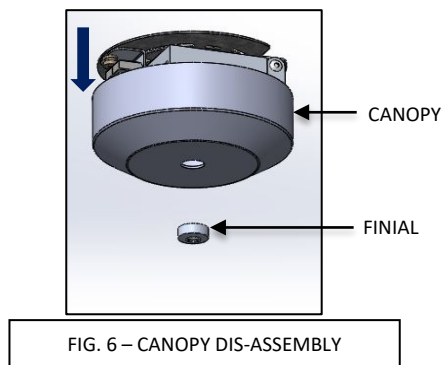

3. Attach MOUNTING BRACKET to JUNCTION BOX (by other) as shown below in FIG. 8.
4. Feed the CORD through FINIAL and CANOPY as shown below in FIG. 9.

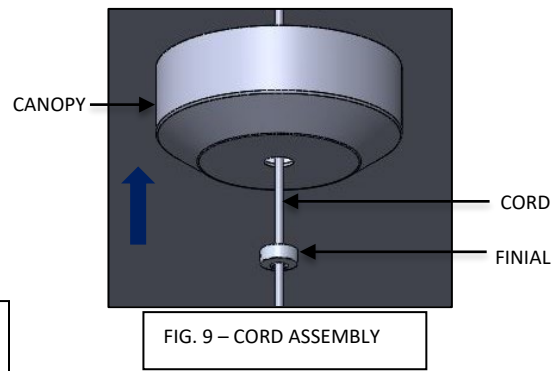
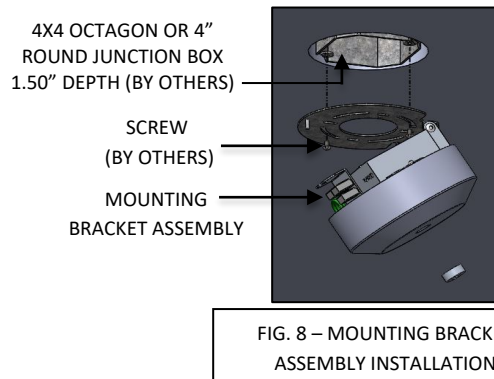

5. Raise the EAU FIXTURE (shown in FIG.10) and pass the cord through MOUNTING BRACKET as shown below in FIG. 11. Adjust fixture drop to desired height. Mark cord with marker inside of DRIVER MOUNTING BRACKET as shown below in FIG. 12. Trim off excess cord leaving minimum of 8.00" past the top of the DRIVER MOUNTING BRACKET all thread.

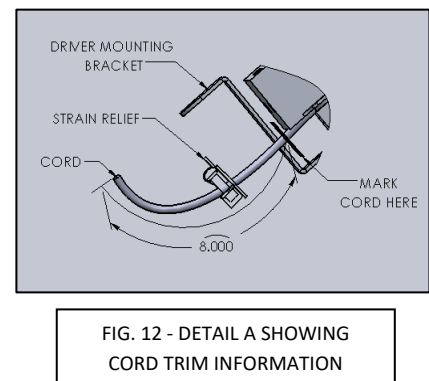
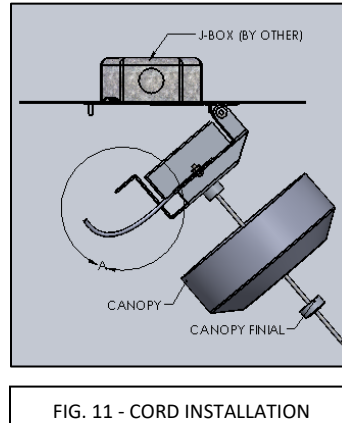
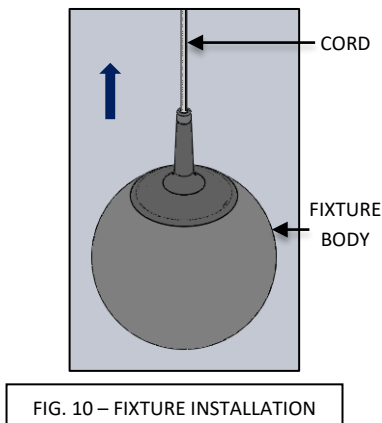

OCL Architectural Lighting

Phone: 314.863.1895

Fax: 314.863.3278

[www.ocl.com](http://www.ocl.com)

## EU1-P1CBX-LED-INSTALLATION-INSTRUCTIONS

6. Insert cord through the strain relief and tighten screws until there is a gap of .063" - .095" between the strain relief body and compression plate (as shown in FIG. 13) above hanging bracket where marked. If screws are not properly tightened cord could slip through the strain relief, causing the fixture to fall.

### WARNING:



**Do not let the EAU LUMINAIRE hang free until CABLE is secured and evenly tensioned.**



FIG. 13 – STRAIN RELIEF  
WITH CORD INSERTED

7. Make wire connections between Building Supply and Fixture Cord inside the junction box (by others) in accordance with the National Electrical Code and all applicable Local and State codes. See WIRE LABEL TABLE and WIRE DIAGRAM shown in FIG. 14 and FIG. 15 for wire connections.

WIRE DIAGRAM TABLE						
SERIES	HANGING SYSTEM	BODY SIZE	BODYLIGHT SOURCE	LED OUTPUT	CONTROL	WIRE DIAGRAM
EU1 (EAU)	P1CBW	12"	STATIC WHITE	LED1	DM1	WIRE DIAGRAM ON PAGE 5
		14"		LED2		
		16"		LED3		

### WIRE DIAGRAM:

WIRE LABEL TABLE		
CONTROL	WIRE COLOR	LABEL
ALL	RED/WHITE	CAP OFF
ALL	BLUE/WHITE	CAP OFF
ALL	GREEN	CAP OFF
ALL	RED	LED(+)
ALL	BLUE	LED(-)

FIG. 12 – WIRE LABEL TABLE

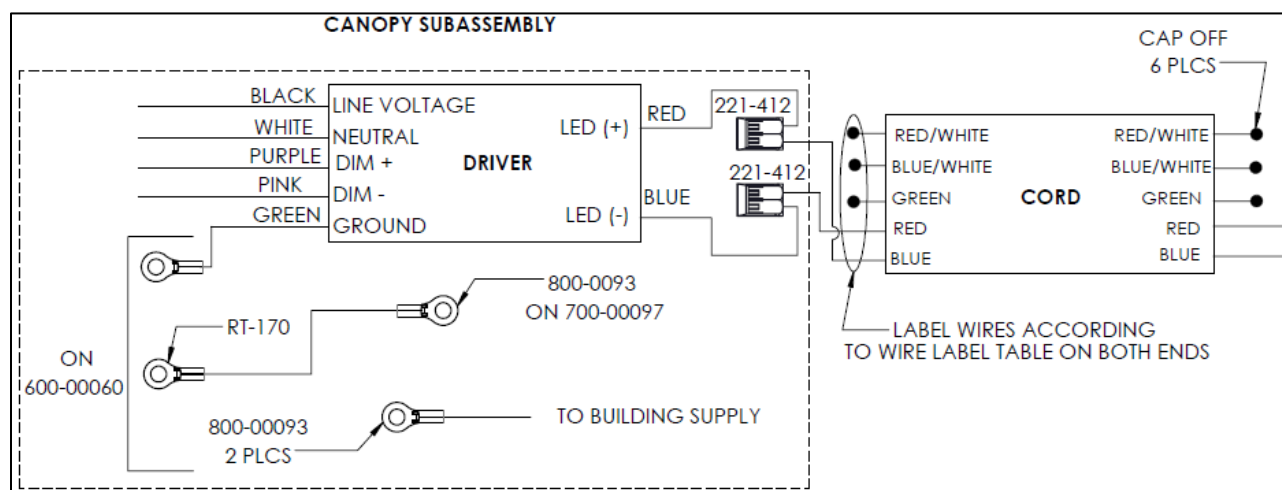

SEE GENERAL NOTE 7 ON PAGE 1

FIG. 13 – WIRE DIAGRAM

**OCL Architectural Lighting**

Phone: 314.863.1895

Fax: 314.863.3278

[www.oclighting.com](http://www.oclighting.com)

## EU1-P1CBX-LED-INSTALLATION-INSTRUCTIONS

8. Swing DRIVER MOUNTING BRACKET back over and secure it with KNURLED NUT removed in STEP 2.
9. Raise CANOPY and secure to ceiling by threading the FINIAL to the NIPPLE (in MOUNTING BRACKET ASSEMBLY) as shown below in FIG. 14.

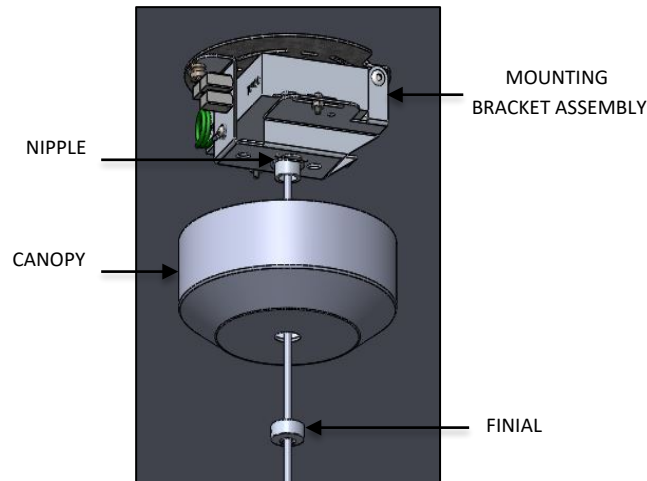

FIG. 14 – FINIAL INSTALLATION

10. Restore power to circuit the EAU series pendant is connected to.
  - a. Test to see that the luminaire turns on after power is restored.
  - b. Contact OCL for any luminaire troubleshooting if a problem occurs.

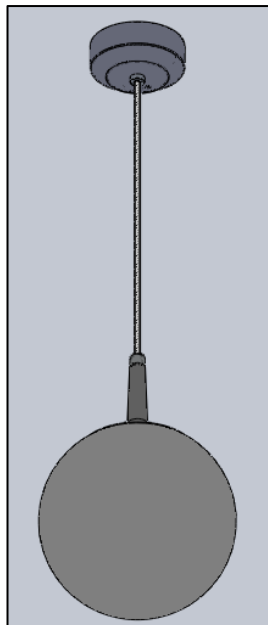

FIG. 15 - COMPLETED INSTALLATION OF EAU PENDANT  
WITH P1CBX HANGING SYSTEM  
EU1-P1CBX-12-WG-XXX-LEDX\_XXK-UNV-XXX-DM1-XXX  
(AS SHOWN)

**OCL Architectural Lighting**

Phone: 314.863.1895

Fax: 314.863.3278

[www.ocl.com](http://www.ocl.com)