

INSTALLATION INSTRUCTIONS

CIRQUE PENDANT WITH P1EC HANGING SYSTEM

These Instructions cover the CIRQUE luminaire with the following options:

SERIES	HANGING SYSTEM	SIZE	LIGHT SOURCE	CONTROL	WIRE DIAGRAM
CQ1: CIRQUE	P1EC: PENDANT WITH 3 ANGLED AIRCRAFT CABLES AND A WHITE POWER CORD TO CANOPY	26"	STATIC WHITE	0-10V DIM 1% (DM1)	WIRE DIAGRAM ON PAGE 06
		38"			
		50"			

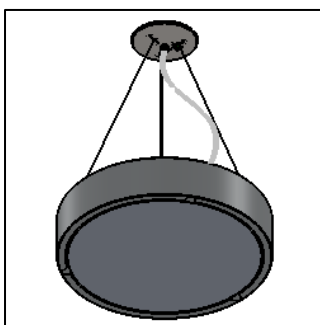

FIG. 1- CQ1-P1EC-26-XX-XXX-LEDX_XXK-UNV-XXX-DM1-XXX

GENERAL NOTES:

- PLEASE COMPLETELY READ THE INSTALL INSTRUCTIONS BEFORE STARTING INSTALLATION.
- TURN OFF POWER TO CIRCUIT FIXTURE WHILE IT IS BEING INSTALLED.
- INSTALL IN ACCORDANCE WITH ALL LOCAL, STATE AND NATIONAL CODES CONSULT WITH A QUALIFIED ELECTRICIAN FOR PROPER INSTALLATION. DUAL CIRCUITING IS STANDARD ON MULTI-BALLAST FIXTURES.
- CAREFULLY UNPACK ALL CONTENTS; SOME COMPONENTS MAY HAVE BEEN SHIPPED IN SEPARATE BOXES MOST FIXTURES ARE SHIPPED PARTIALLY ASSEMBLED. SOME UN ASSEMBLY MAY BE REQUIRED FOR INSTALLATION.
- DO NOT LET THE CIRQUE LUMINAIRE HANG FREE UNTIL ALL THE CABLE IS SECURED AND EVENLY TENSIONED.
- UPON RECEIPT OF THE FIXTURE, THOROUGHLY INSPECT FOR ANY FREIGHT DAMAGE. ANY DAMAGE SHOULD BE BROUGHT TO THE ATTENTION OF THE DELIVERY CARRIER.
- THESE INSTRUCTIONS DO NOT CLAIM TO COVER ALL DETAILS OR VARIATIONS IN THE EQUIPMENT, PROCEDURE, OR PROCESS DESCRIBED; NOR DO THEY PROVIDE DIRECTIONS FOR MEETING EVERY POSSIBLE CONTINGENCY DURING INSTALLATION, OPERATION, OR MAINTENANCE.
- WHEN ADDITIONAL INFORMATION IS DESIRED TO SATISFY A PROBLEM NOT COVERED SUFFICIENTLY FOR USER'S PURPOSE, PLEASE CONTACT YOUR NEAREST REPRESENTATIVE.
- THESE INSTRUCTIONS COVER VARIOUS SIZES AND LAMPING OPTIONS. FIXTURE SHOWN IN INSTRUCTIONS MAY DIFFER FROM FIXTURE BEING INSTALLED. INSTALLATION STEPS ARE THE SAME HOWEVER.
- DUE TO A CHANGE IN NEC SECTION 410.69 EFFECTIVE IN 2022, THE COLOR PINK WILL BE USED IN PLACE OF GRAY FOR 0-10V CONTROL. NOTE THAT EXISTING SYSTEMS AND FIXTURES MANUFACTURED PRIOR TO 2022 MAY STILL USE GRAY WIRE AS AN UNGROUNDED CONDUCTOR FOR 0-10V CONTROL. CARE SHOULD BE TAKEN WHEN WORKING ON EXISTING SYSTEMS.

OCL Architectural Lighting

Phone: 314.863.1895

Fax: 314.863.3278

www.ocl.com

Table of Contents

GENERAL INFORMATION:.....	3
MOUNTING:.....	4
CIRQUE MOUNTING [CANOPY]:.....	4

CQ1-P1EC-XX-LED-INSTALLATION INSTRUCTIONS

GENERAL INFORMATION:

You will receive the following with each CIRQUE series pendant fixture:

1. TRIM RING. (Pre-assembled with reflector and cord as shown in FIG. 2)
2. DIFFUSER. (as shown in FIG.3)
3. INSTALLATION INSTRUCTIONS (shown in FIG. 4) - Please completely read the install instructions before starting installation.
4. RED BAG (shown in FIG. 4) contains below following items
 - a. SCREWS. (as shown in FIG. 5)
 - b. CANOPY. (as shown in FIG. 6)
 - c. MOUNTING KIT CONTENTS (as shown on FIG. 7)
 - I. MOUNTING BRACKET ASSEMBLY
 - II. FINIAL

WARNING: Examine all components for any damage before beginning installation.

WARNING: This fixture should be installed by a licensed electrician only.

WARNING: Be careful not to scratch or damage any finished parts.

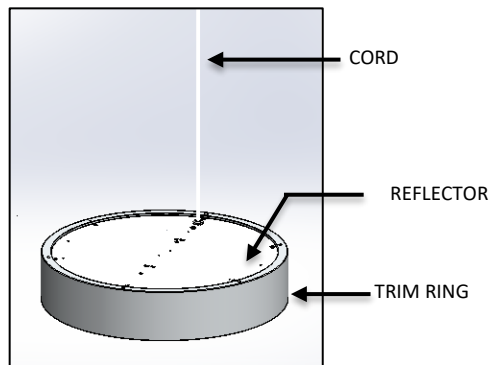

FIG. 2 TRIM RING

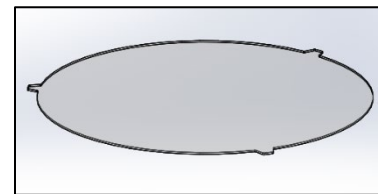

FIG. 3 DIFFUSER

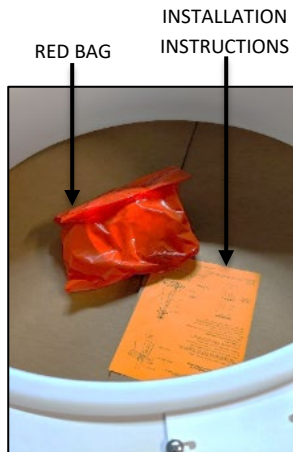

FIG. 4 RED BAG AND
INSTALLATION INSTRUCTIONS

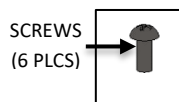

FIG. 5 RED BAG
CONTENTS

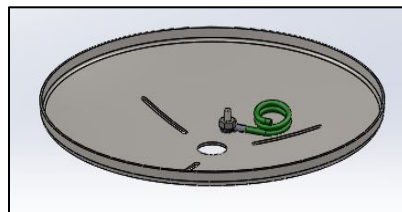

FIG. 6 CANOPY

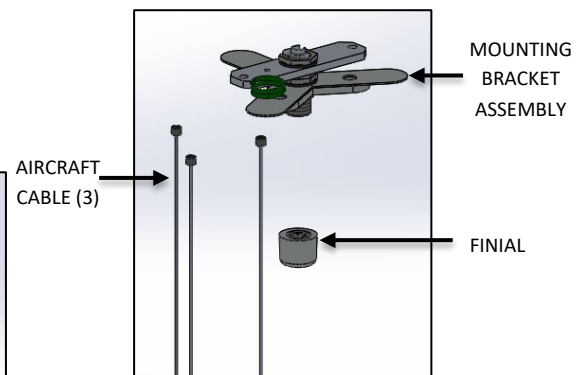

FIG. 7 MOUNTING KIT

OCL Architectural Lighting

Phone: 314.863.1895

Fax: 314.863.3278

www.ocllighting.com

MOUNTING:

CIRQUE MOUNTING [CANOPY]:

1. Loosen the CANOPY FINIAL and remove CANOPY as shown in FIG. 8. Be careful not to scratch finish and Feed the AIRCRAFT CABLES (3) through the holes of MOUNTING BRACKET ASSEMBLY as shown in FIG. 9.

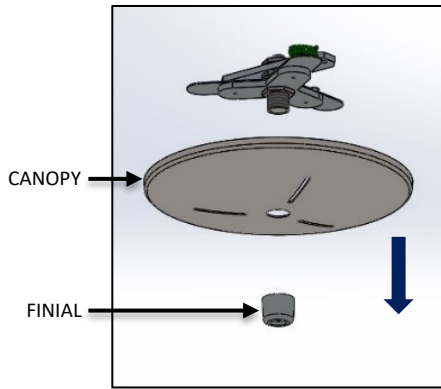
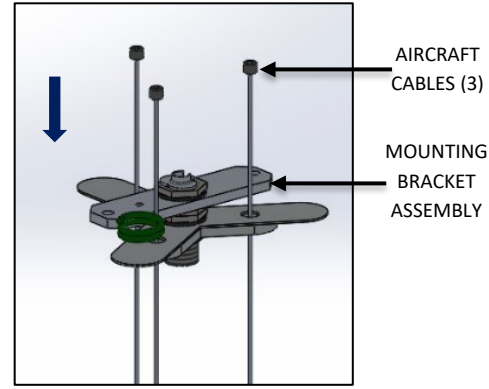

FIG. 8 – CANOPY DIS-ASSEMBLY

FIG. 9 – AIRCRAFT CABLE
INSTALLATION

2. Secure the MOUNTING BRACKET ASSEMBLY along with AIRCRAFT CABLES to the JUNCTION BOX (by others) as shown below in FIG. 10.
3. Feed the remaining AIRCRAFT CABLES (3) from the MOUNTING BRACKET ASSEMBLY through the slots of the CANOPY. Loosely secure CANOPY to the ceiling by threading the FINIAL to the MOUNTING BRACKET ASSEMBLY as shown below in FIG. 11.

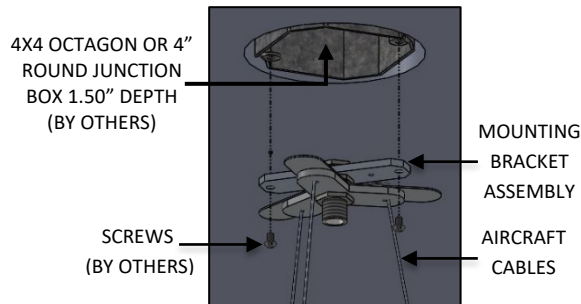
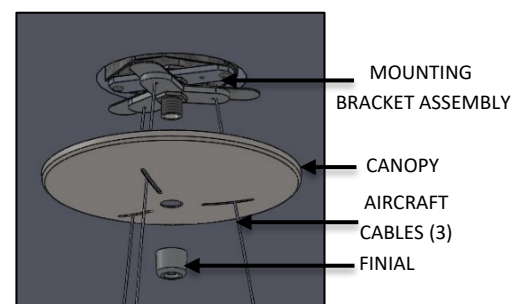

FIG. 10 – MOUNTING
BRACKET ASSEMBLY

FIG. 11 – CANOPY INSTALLATION

4. Place the DIFFUSER into the TRIM RING by lightly bending the DIFFUSER in a taco shape as shown below in FIG. 12 & 13.

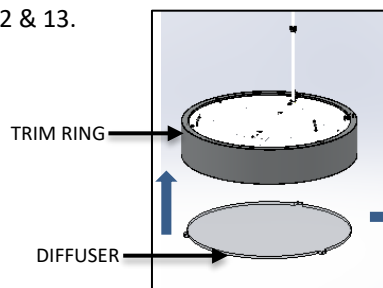

FIG. 12 – DIFFUSER INSTALLATION

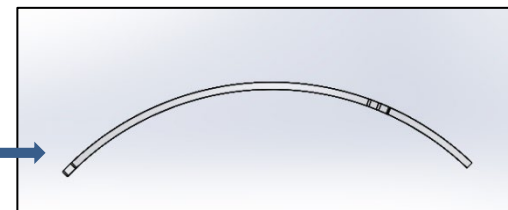

FIG. 13 – DIFFUSER BENT IN TACO SHAPE

OCL Architectural Lighting

Phone: 314.863.1895

Fax: 314.863.3278

www.oclighting.com

CQ1-P1EC-XX-LED-INSTALLATION INSTRUCTIONS

5. Raise the CRIQUE fixture with multiple people and feed ALL THREE AIRCRAFT CABLE into the GRIPLOCK, press the plunger of the GRIPLOCK and insert the AIRCRAFT CABLE at least 1.75" into the body of the GRIPLOCK as shown in FIG. 14.



WARNING:

Do not let the CRIQUE ASSEMBLY hang free until ALL THE CABLES secured and evenly tensioned.

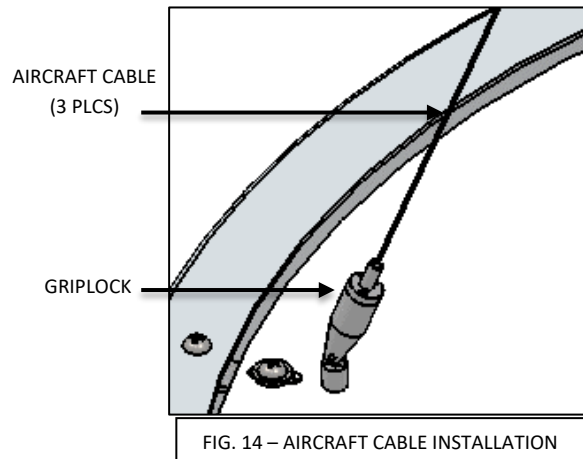

6. Once the CRIQUE ASSEMBLY is secured to the AIRCRAFT CABLE (3) at the GRIPLOCK (3) Unthread the FINIAL from the MOUNTING BRACKET ASSEMBLY and lower the CANOPY as shown below in FIG. 15.
7. Feed POWER CORD through the center hole in the CANOPY and make secure connection by passing through the NIPPLE (available in mounting bracket assembly) as shown below in FIG. 16.

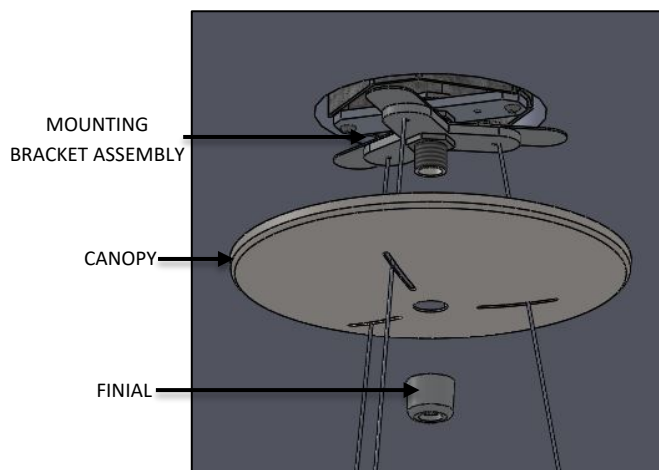

FIG. 15 – CANOPY DISASSEMBLY

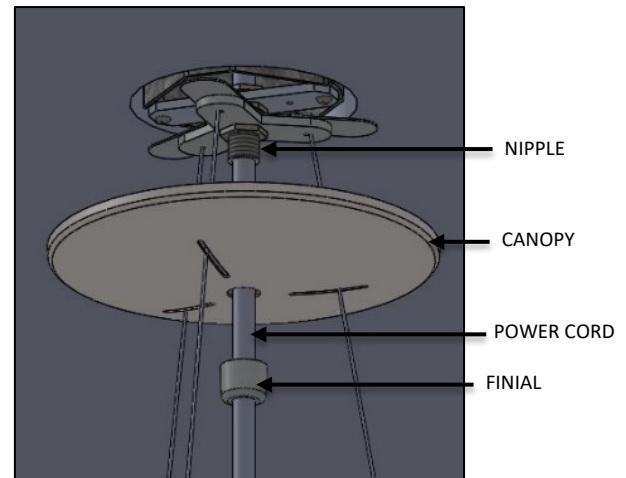

FIG. 16 – CORD INSTALLATION

OCL Architectural Lighting

Phone: 314.863.1895

Fax: 314.863.3278

www.ocl.com

CQ1-P1EC-XX-LED-INSTALLATION INSTRUCTIONS

8. Make all wire connections in accordance with the NATIONAL ELECTRICAL CODE and all applicable LOCAL AND STATE CODES inside the JUNCTION BOX (BY OTHERS). See WIRE DIAGRAM and WIRE LABEL TABLE below as shown in FIG. 17 & 18.

SERIES	HANGING SYSTEM	BODY SIZE	BODYLIGHT SOURCE	LED OUTPUT	CONTROL	WIRE DIAGRAM
CQ1: CIRQUE	P1EC: PENDANT WITH 3 ANGLED AIRCRAFT CABLES AND A WHITE POWER CORD TO CANOPY	26"	STATIC WHITE	LED1	0-10V DIM 1% (DM1)	WIRE DIAGRAM ON PAGE 06
				LED2		
		38"	STATIC WHITE	LED1	0-10V DIM 1% (DM1)	
				LED2		
		50"	STATIC WHITE	LED1	0-10V DIM 1% (DM1)	
				LED2		

WIRE LABEL TABLE		
CONTROL	WIRE COLOR	LABEL
ALL	BLACK	LINE VOLTAGE
ALL	WHITE	NEUTRAL
ALL	GREEN	GROUND
DM1	PURPLE	0-10V (+)
DM1	PINK	0-10V (-)

FIG. 17 – WIRE LABEL TABLE

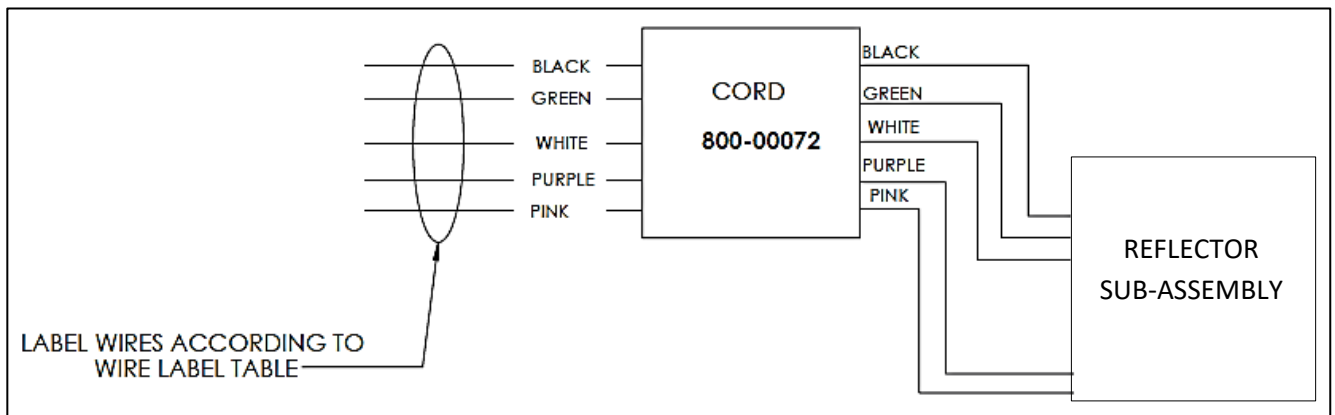

SEE GENERAL NOTE 10 ON PAGE 1

FIG. 18 – WIRE DIAGRAM

OCL Architectural Lighting

Phone: 314.863.1895

Fax: 314.863.3278

www.oclighting.com

CQ1-P1EC-XX-LED-INSTALLATION INSTRUCTIONS

9. Raise CANOPY and secure to ceiling by threading the FINIAL to the NIPPLE (available in MOUNTING BRACKET ASSEMBLY) as shown below in FIG. 19.

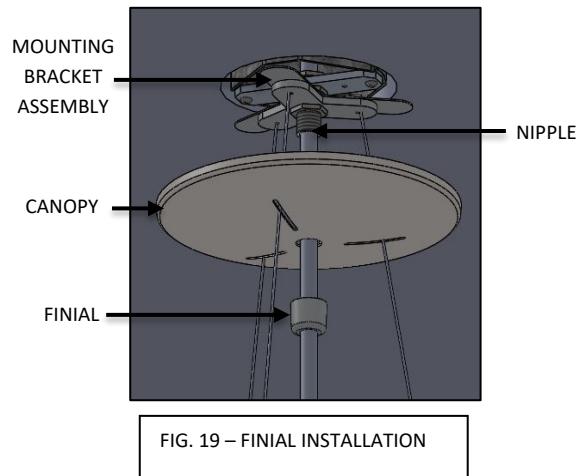

10. Restore power to circuit the CIRQUE series pendant is connected to.
 - a. Test to see that the luminaire turns on after power is restored.
 - b. Contact OCL for any luminaire troubleshooting if a problem occurs.

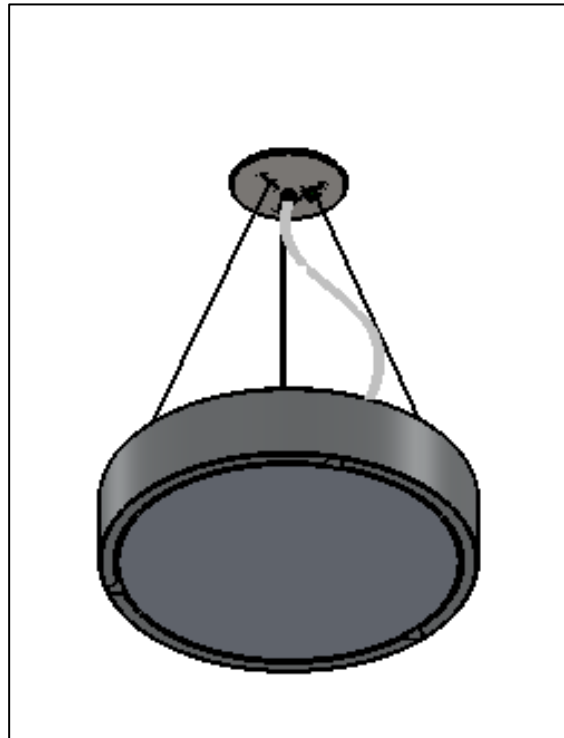

FIG. 20- CQ1-P1EC-26-XX-XXX-LEDX_XXK-UNV-XXX-DM1-XXX

OCL Architectural Lighting

Phone: 314.863.1895

Fax: 314.863.3278

www.ocl.com